

# Installation Instructions



## STOPLIGHT SWITCH KIT

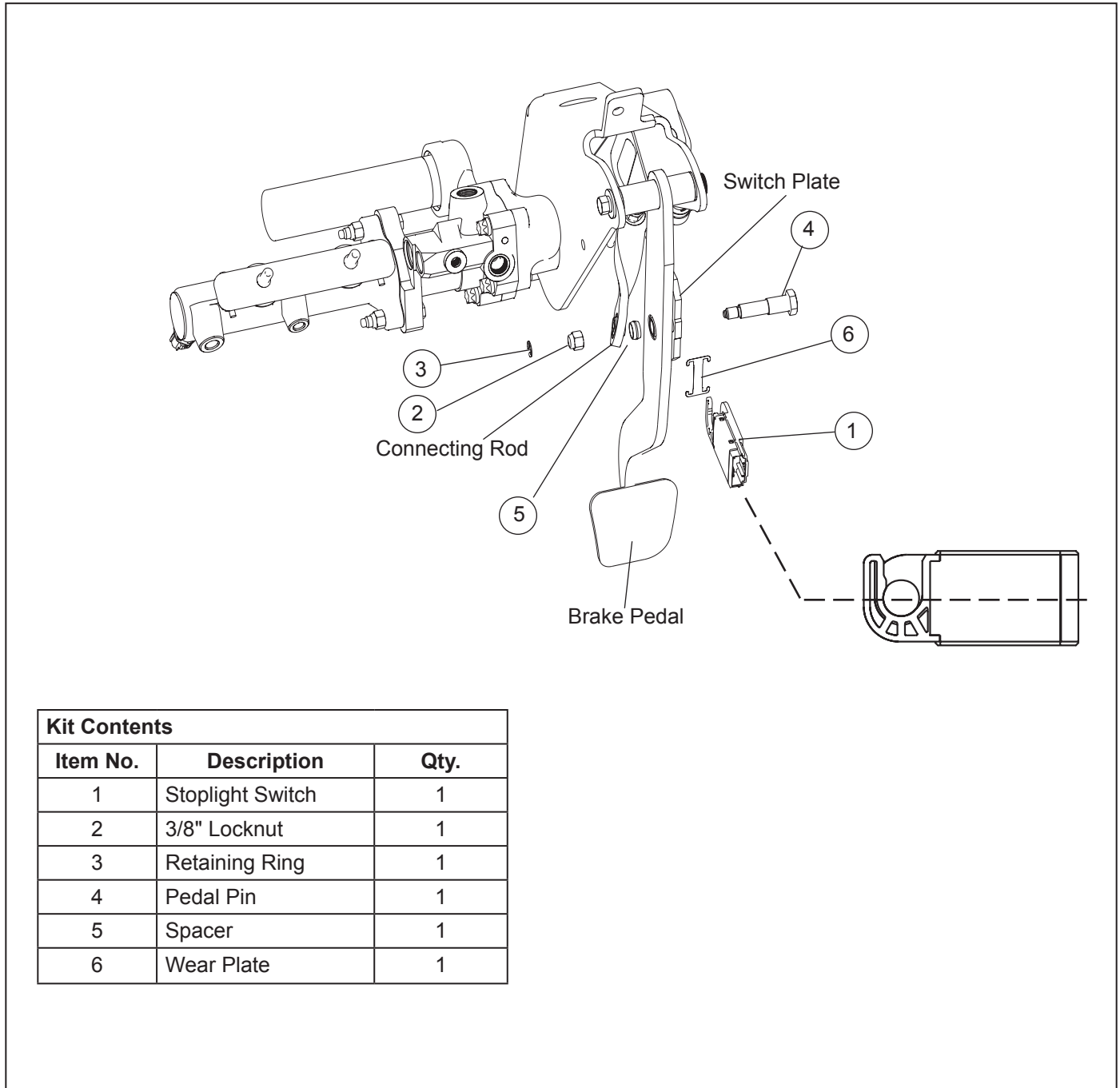

Figure 1 – Stoplight Switch Kit Contents

### DESCRIPTION

This kit contains all of the components necessary to replace the stoplight switch on the Blue Diamond brake control module for hydraulic brake low cab forward (LCF) International® and Ford® trucks. The components contained in the kit are shown above.



## GENERAL SAFETY GUIDELINES

**WARNING! PLEASE READ AND FOLLOW THESE INSTRUCTIONS**

**TO AVOID PERSONAL INJURY OR DEATH:**

**When working on or around a vehicle, the following guidelines should be observed AT ALL TIMES:**

- ▲ Park the vehicle on a level surface, apply the parking brakes and always block the wheels. Always wear personal protection equipment.
- ▲ Stop the engine and remove the ignition key when working under or around the vehicle. When working in the engine compartment, the engine should be shut off and the ignition key should be removed. Where circumstances require that the engine be in operation, **EXTREME CAUTION** should be used to prevent personal injury resulting from contact with moving, rotating, leaking, heated or electrically-charged components.
- ▲ Do not attempt to install, remove, disassemble or assemble a component until you have read, and thoroughly understand, the recommended procedures. Use only the proper tools and observe all precautions pertaining to use of those tools.
- ▲ If the work is being performed on the vehicle's air brake system, or any auxiliary pressurized air systems, make certain to drain the air pressure from all reservoirs before beginning ANY work on the vehicle. If the vehicle is equipped with a Bendix® AD-IS® air dryer system, a Bendix® DRM™ dryer reservoir module, or a Bendix® AD-9si® air dryer, be sure to drain the purge reservoir.
- ▲ Following the vehicle manufacturer's recommended procedures, deactivate the electrical system in a manner that safely removes all electrical power from the vehicle.
- ▲ Never exceed manufacturer's recommended pressures.
- ▲ Never connect or disconnect a hose or line containing pressure; it may whip and/or cause hazardous airborne dust and dirt particles. Wear eye protection. Slowly open connections with care, and verify that no pressure is present. Never remove a component or plug unless you are certain all system pressure has been depleted.
- ▲ Use only genuine Bendix® brand replacement parts, components and kits. Replacement hardware, tubing, hose, fittings, wiring, etc. must be of equivalent size, type and strength as original equipment and be designed specifically for such applications and systems.
- ▲ Components with stripped threads or damaged parts should be replaced rather than repaired. Do not attempt repairs requiring machining or welding unless specifically stated and approved by the vehicle and component manufacturer.
- ▲ Prior to returning the vehicle to service, make certain all components and systems are restored to their proper operating condition.
- ▲ For vehicles with Automatic Traction Control (ATC), the ATC function must be disabled (ATC indicator lamp should be ON) prior to performing any vehicle maintenance where one or more wheels on a drive axle are lifted off the ground and moving.
- ▲ The power **MUST** be temporarily disconnected from the radar sensor whenever any tests **USING A DYNAMOMETER** are conducted on a vehicle equipped with a Bendix® Wingman® system.
- ▲ You should consult the vehicle manufacturer's operating and service manuals, and any related literature, in conjunction with the Guidelines above.

## REMOVAL OF STOPLIGHT SWITCH

1. Disconnect the electrical connector to the stoplight switch (1).
2. Remove the retaining ring (3), locknut (2), connecting rod and spacer (5) from the pedal pin (4).
3. Remove the pedal pin (4), stoplight switch (1), and wear plate (6).

## ASSEMBLY

Use the contents contained in this kit for assembly.

1. Position the wear plate (6) on the stoplight switch (1).
2. Install the stoplight switch and wear plate on the brake pedal arm straddling the switch plate. *See Figure 1 for orientation.*
3. Align the pedal pin hole in the switch with the hole in the brake pedal arm and switch plate.
4. Slide the pedal pin (4) through the switch plate, switch, and brake pedal arm.
5. Insert the spacer (5) between the brake pedal arm and the connecting rod and slide the pedal pin through both.
6. Secure with the 3/8" locknut (2). Tighten to 180-220 in-lbs.
7. Install the retaining ring (3) in the retaining ring groove on the end of the pedal pin (4). Ensure the retaining ring is secure.
8. Connect the electrical connector to the new stoplight switch (1). An audible click ensures the connector is properly seated.

## TESTING THE SYSTEM

Before moving the vehicle, check the system for correct operation.

1. With the engine off, depress the brake pedal and verify pedal resistance.
2. Start the engine. Depress the brake pedal and verify that the pedal and stoplights operate per the vehicle manufacturer's specifications.

### Log-on and Learn from the Best

On-line training that's available when you are –24/7/365.  
Visit [www.brake-school.com](http://www.brake-school.com).

