



Installation Instructions

Bracket Assembly for Bendix® Wingman® FLR10™ Radar Sensors

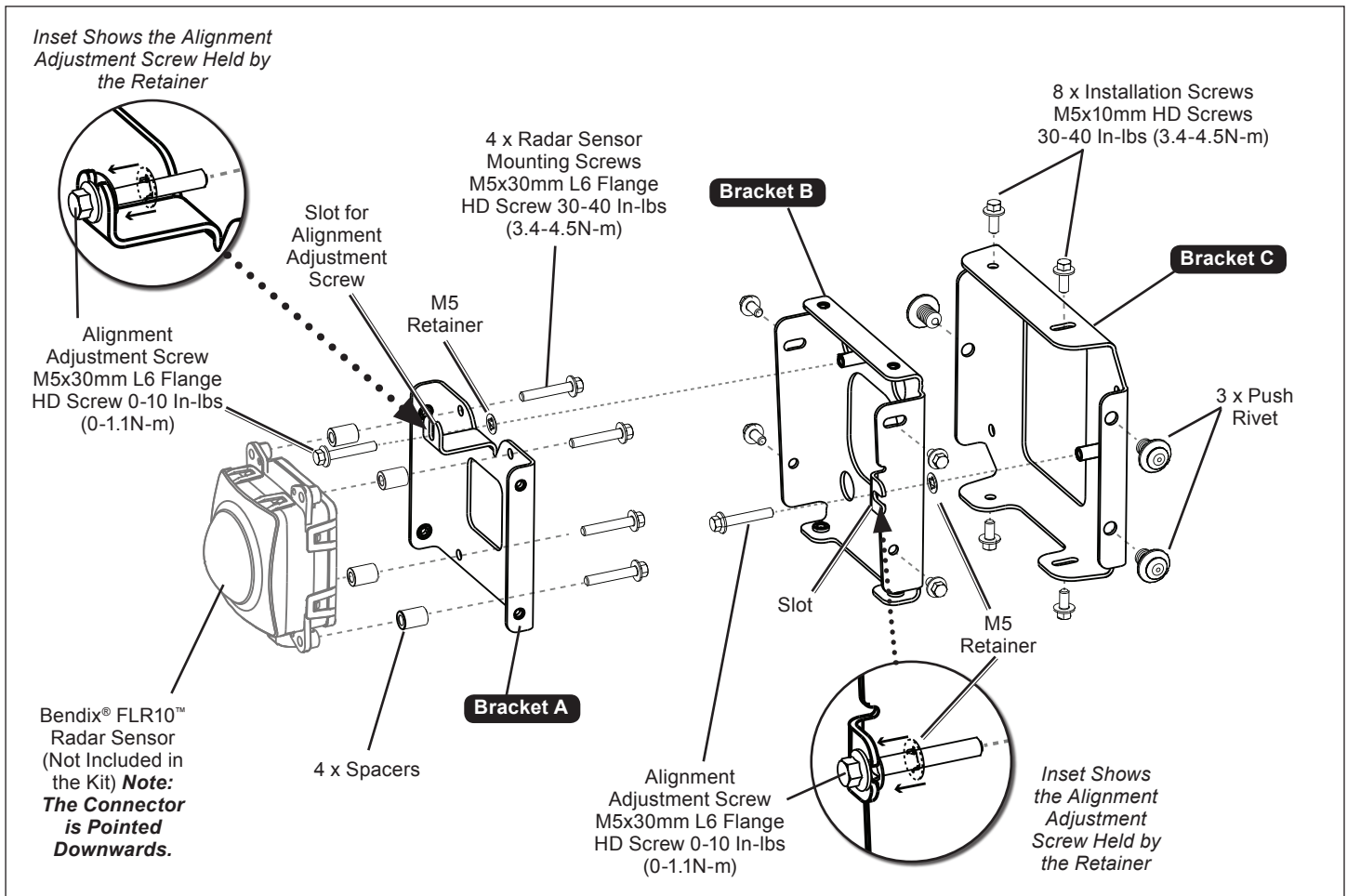

FIGURE 1 - EXPLODED VIEW OF KIT COMPONENTS

The vehicle must be parked on level ground. Switch off the ignition and disconnect the battery.

Read and understand this document before beginning work. See the *General Safety Guidelines* below.

GENERAL SAFETY GUIDELINES

WARNING!

PLEASE READ AND FOLLOW THESE INSTRUCTIONS TO AVOID PERSONAL INJURY OR DEATH:

When working on or around a vehicle, the following general precautions should be observed at all times.

1. Park the vehicle on a level surface, apply the parking brakes, and always block the wheels. Always wear safety glasses.
2. Stop the engine and remove ignition key when working under or around the vehicle. When working in the engine compartment, the engine should be shut off and the ignition key should be removed. Where circumstances require that the engine be in operation, **EXTREME CAUTION** should be used to prevent personal injury resulting from contact with moving, rotating, leaking, heated or electrically charged components.
3. Do not attempt to install, remove, disassemble or assemble a component until you have read and thoroughly understand the recommended procedures. Use only the proper tools and observe all precautions pertaining to use of those tools.
4. If the work is being performed on the vehicle's air brake system, or any auxiliary pressurized air systems, make certain to drain the air pressure from all reservoirs before beginning **ANY** work

on the vehicle. If the vehicle is equipped with a Bendix® AD-IS® air dryer system or a dryer reservoir module, be sure to drain the purge reservoir.

5. Following the vehicle manufacturer's recommended procedures, deactivate the electrical system in a manner that safely removes all electrical power from the vehicle.
6. Never exceed manufacturer's recommended pressures.
7. Never connect or disconnect a hose or line containing pressure; it may whip. Never remove a component or plug unless you are certain all system pressure has been depleted.
8. Use only genuine Bendix® brand replacement parts, components and kits. Replacement hardware, tubing, hose, fittings, etc. must be of equivalent size, type and strength as original equipment and be designed specifically for such applications and systems.
9. Components with stripped threads or damaged parts should be replaced rather than repaired. Do not attempt repairs requiring machining or welding unless specifically stated and approved by the vehicle and component manufacturer.
10. Prior to returning the vehicle to service, make certain all components and systems are restored to their proper operating condition.
11. For vehicles with Automatic Traction Control (ATC), the ATC function must be disabled (ATC indicator lamp should be ON) prior to performing any vehicle maintenance where one or more wheels on a drive axle are lifted off the ground and moving.

Use the Assembly Torques shown in Figure 1.

Removal

1. Locate the original radar sensor and remove the harness. Be sure to protect the harness and connector from damage.
2. Remove the entire bracket assembly from the vehicle. On a workbench, remove the radar sensor from the bracket.

Assembly

3. Install the Push Rivets into Bracket C. Set aside.
4. Using the four (4) spacers, install the radar sensor onto Bracket A using the four (4) Sensor Mounting screws.
5. Mount Bracket A to Bracket B using the Installation Screws (use the mid-point of the side slots as a temporary location). Similarly mount Bracket B to Bracket C.
6. Install one Alignment Adjustment screw into Bracket A and one into Bracket B, passing them first through the slot shown, then onto the M5 Retainers. *(See Inset Diagrams.)* The amount that the Alignment Adjustment screws insert into the bracket behind is used to align the radar.
7. Mount the assembly to the vehicle and install the harness.
8. Follow the alignment procedure in SD-61-4962 (previously SD-13-4962). Check for any Diagnostic Trouble Codes before returning the vehicle to service.