

# Installation Instructions



## BELL CRANK KIT

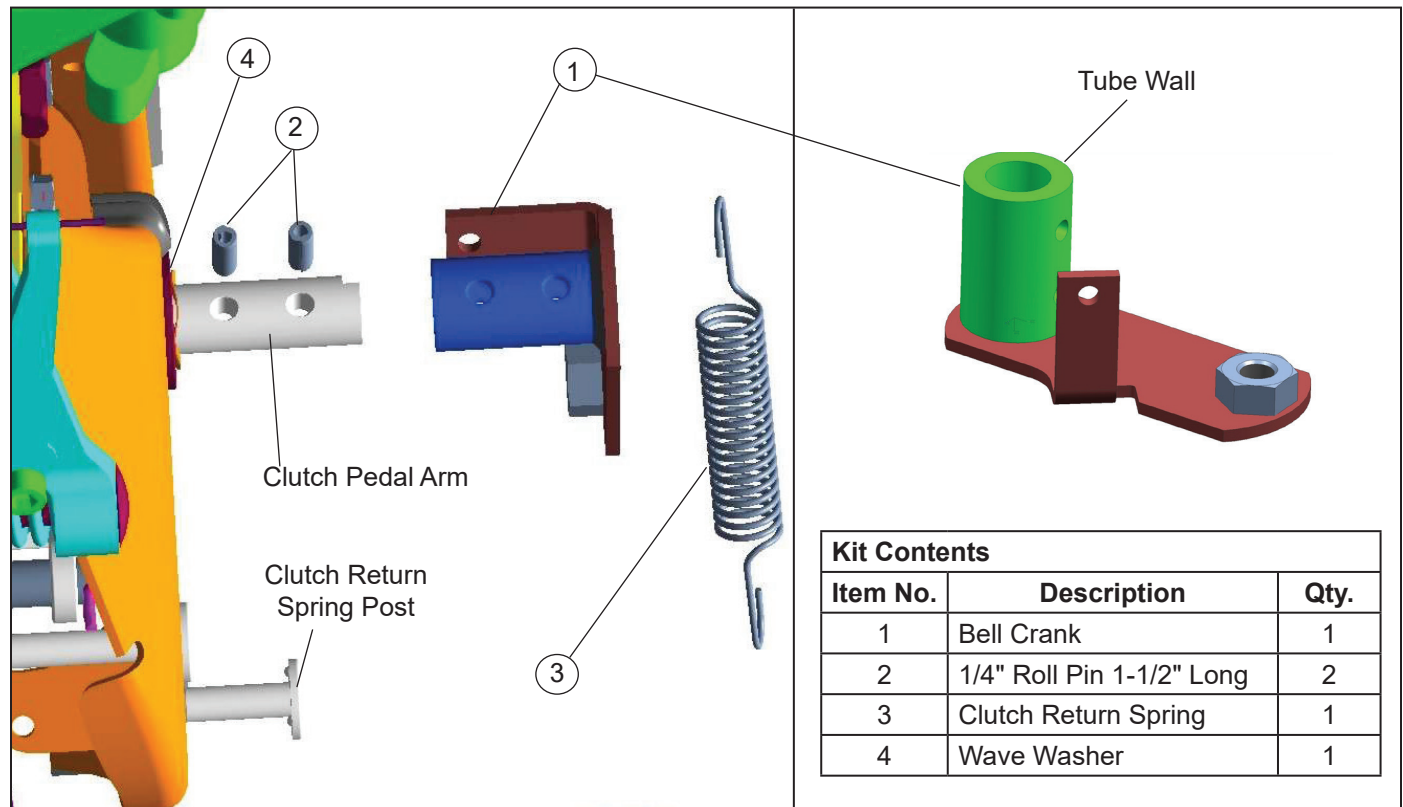

Figure 1 – Bell Crank Kit

### DESCRIPTION

This kit contains all of the components necessary to replace the bell crank. Before installing this kit, be sure to read the General Safety Guidelines on the following page.

### DISASSEMBLY

1. Disconnect the throttle linkage by removing the shoulder bolt that secures the linkage to the bell crank (1).
2. Remove the clutch return spring (3) from the bell crank (1) and the clutch return spring post.
3. Fully depress the clutch pedal and clamp into position.
4. With a hammer and punch, drive the roll pins (2) out of the bell crank (1), leaving the wave washer (4) in place.
5. Slide the bell crank (1) off the clutch pedal arm.
6. Slide the wave washer (4) off the clutch pedal arm and discard.

### ASSEMBLY

1. Slide the wave washer (4), included in the kit, onto the clutch pedal arm.

2. Slide the bell crank (1) over the clutch pedal arm. The flat on the clutch pedal arm and the internal flat of the bell crank prevents incorrect alignment. Note that the tube wall of the replacement bell crank may be thicker than the one being removed. Slide into position until the roll pin holes align.
3. Install the two 1-1/2" long roll pins (2) using a hammer and punch if necessary. *NOTE: The roll pins should be centered on the bell crank tube outside diameter, with approximately 1/8" of the roll pin length extending out each side of the bell crank tube outside diameter.*
4. Release the clutch pedal clamping mechanism.
5. Install the clutch return spring (3) on the bell crank (1) and the clutch return spring post.
6. Reconnect the throttle linkage and secure it with the shoulder bolt. Tighten to 55-67 ft-lbs.
7. Adjust the throttle linkage free play per the vehicle manufacturer's guidelines.

### TESTING

Verify the clutch pedal operates per the vehicle manufacturer's specifications.

## GENERAL SAFETY GUIDELINES WARNING! PLEASE READ AND FOLLOW THESE INSTRUCTIONS TO AVOID PERSONAL INJURY OR DEATH:

When working on or around a vehicle, the following guidelines should be observed AT ALL TIMES:

- ▲ Park the vehicle on a level surface, apply the parking brakes and always block the wheels. Always wear personal protection equipment.
- ▲ Stop the engine and remove the ignition key when working under or around the vehicle. When working in the engine compartment, the engine should be shut off and the ignition key should be removed. Where circumstances require that the engine be in operation, EXTREME CAUTION should be used to prevent personal injury resulting from contact with moving, rotating, leaking, heated or electrically-charged components.
- ▲ Do not attempt to install, remove, disassemble or assemble a component until you have read, and thoroughly understand, the recommended procedures. Use only the proper tools and observe all precautions pertaining to use of those tools.
- ▲ If the work is being performed on the vehicle's air brake system, or any auxiliary pressurized air systems, make certain to drain the air pressure from all reservoirs before beginning ANY work on the vehicle. If the vehicle is equipped with a Bendix® AD-IS® air dryer system, a Bendix® DRM™ dryer reservoir module, a Bendix® AD-9si®, AD-HF®, or AD-HF®i air dryer, be sure to drain the purge reservoir.
- ▲ Following the vehicle manufacturer's recommended procedures, deactivate the electrical system in a manner that safely removes all electrical power from the vehicle.
- ▲ Never exceed manufacturer's recommended pressures.
- ▲ Never connect or disconnect a hose or line containing pressure; it may whip and/or cause hazardous airborne dust and dirt particles. Wear eye protection. Slowly open connections with care, and verify that no pressure is present. Never remove a component or plug unless you are certain all system pressure has been depleted.
- ▲ Use only genuine Bendix® brand replacement parts, components and kits. Replacement hardware, tubing, hose, fittings, wiring, etc. must be of equivalent size, type and strength as original equipment and be designed specifically for such applications and systems.
- ▲ Components with stripped threads or damaged parts should be replaced rather than repaired. Do not attempt repairs requiring machining or welding unless specifically stated and approved by the vehicle and component manufacturer.
- ▲ Prior to returning the vehicle to service, make certain all components and systems are restored to their proper operating condition.
- ▲ For vehicles with Automatic Traction Control (ATC), the ATC function must be disabled (ATC indicator lamp should be ON) prior to performing any vehicle maintenance where one or more wheels on a drive axle are lifted off the ground and moving.
- ▲ The power MUST be temporarily disconnected from the radar sensor whenever any tests USING A DYNAMOMETER are conducted on a vehicle equipped with a Bendix® Wingman® system.
- ▲ You should consult the vehicle manufacturer's operating and service manuals, and any related literature, in conjunction with the Guidelines above.

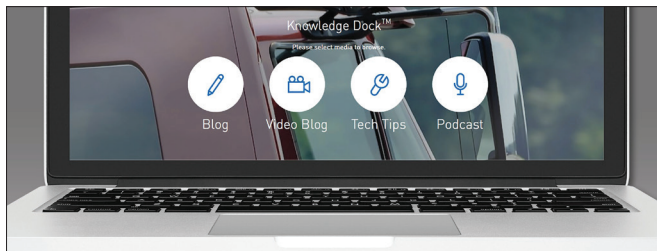

**Trucking moves fast. Move faster.**

**Knowledge Dock™**

• BLOGS • PODCASTS • VIDEOS • 24/7/365

[ [knowledge-dock.com](http://knowledge-dock.com) ]



# Bendix®



### Log On and Learn from the Best

Online training that's available when you are – 24/7/365.  
Visit [brake-school.com](http://brake-school.com).