



Installation Instructions

KIT
Piece No. 801747

Bendix® Cyclone DuraDrain™ Trailer Water Separator

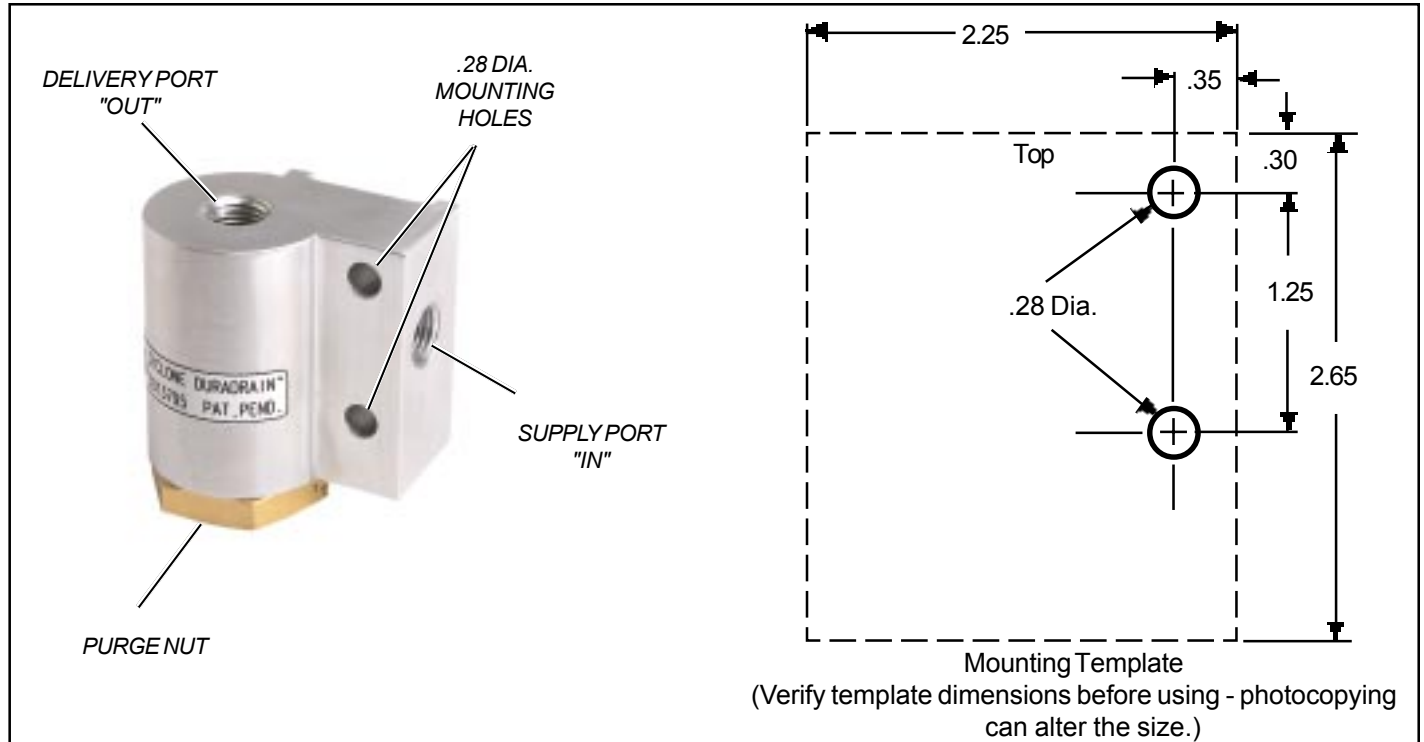

Figure 1 - Bendix® Cyclone DuraDrain™ trailer water separator

WARNING! PLEASE READ AND FOLLOW THESE INSTRUCTIONS TO AVOID PERSONAL INJURY OR DEATH:

When working on or around a vehicle, the following general precautions should be observed at all times.

1. Park the vehicle on a level surface, apply the parking brakes, and always block the wheels. Always wear safety glasses.
2. Stop the engine and remove ignition key when working under or around the vehicle. When working in the engine compartment, the engine should be shut off and the ignition key should be removed. Where circumstances require that the engine be in operation, **EXTREME CAUTION** should be used to prevent personal injury resulting from contact with moving, rotating, leaking, heated or electrically charged components.
3. Do not attempt to install, remove, disassemble or assemble a component until you have read and thoroughly understand the recommended procedures. Use only the proper tools and observe all precautions pertaining to use of those tools.

4. If the work is being performed on the vehicle's air brake system, or any auxiliary pressurized air systems, make certain to drain the air pressure from all reservoirs before beginning ANY work on the vehicle. If the vehicle is equipped with an AD-IS™ air dryer system or a dryer reservoir module, be sure to drain the purge reservoir.
5. Following the vehicle manufacturer's recommended procedures, deactivate the electrical system in a manner that safely removes all electrical power from the vehicle.
6. Never exceed manufacturer's recommended pressures.
7. Never connect or disconnect a hose or line containing pressure; it may whip. Never remove a component or plug unless you are certain all system pressure has been depleted.
8. Use only genuine Bendix® replacement parts, components and kits. Replacement hardware, tubing, hose, fittings, etc. must be of equivalent size, type and strength as original equipment and be designed specifically for such applications and systems.

Caution: Template included do not resize this document.

9. Components with stripped threads or damaged parts should be replaced rather than repaired. Do not attempt repairs requiring machining or welding unless specifically stated and approved by the vehicle and component manufacturer.

10. Prior to returning the vehicle to service, make certain all components and systems are restored to their proper operating condition.

11. For vehicles with Antilock Traction Control (ATC), the ATC function must be disabled (ATC indicator lamp should be ON) prior to performing any vehicle maintenance where one or more wheels on a drive axle are lifted off the ground and moving.

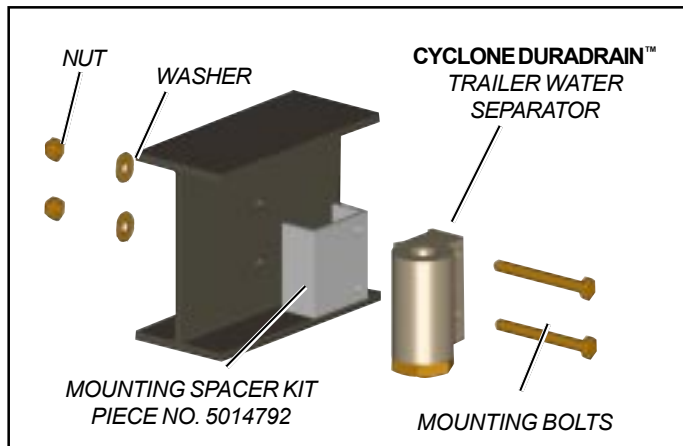

FIGURE 2 - INSTALLATION

DESCRIPTION

The Cyclone DuraDrain™ trailer water separator can be installed in the trailer control or in the supply line near the gladhand. As air enters the trailer water separator a cyclonic action separates out water and particulates, removing more than 95% of the water that passes through it. The removal of water and contaminants reduces brake drag and improves the life of the trailer system components.

REMOVING - (REPLACEMENT)

1. Disconnect the supply and delivery line fittings.
2. Remove the mounting hardware, and spacer if applicable, that secures the Cyclone DuraDrain™ trailer water separator to the trailer frame rail.

INSTALLATION

A Cyclone DuraDrain™ trailer water separator can be installed in the control and/or the supply line of the trailer between the gladhand and the first valve in the trailer system. See Figure 3 Trailer Schematic.

1. Identify the control and/or the supply line to which the Cyclone DuraDrain™ trailer water separator is to be installed. The trailer water separator should be installed at the lowest point on the air line. The Cyclone DuraDrain™ trailer water separator must be installed vertically with the purge nut pointing down to the ground to allow for adequate draining.
2. Locate a mounting position on the trailer frame rail or crossmember. Using the Cyclone DuraDrain™ trailer water separator as a template, mark the location of the mounting holes. Carefully drill two mounting holes. Consult with the trailer manufacturer prior to drilling any holes in the frame rail or crossmember. If a mounting spacer is used, install as shown in Figure 3. Secure using grade 2 or 5 mounting hardware.
3. Cut the air line and install a 3/8" NPT male fitting at each end.

Note: The relay valve and the air line in which the Cyclone DuraDrain™ trailer water separator is to be installed may contain contaminants and water. To ensure optimal performance of the Cyclone DuraDrain™ trailer water separator, disconnect the air line at the relay valve and clean the line with shop air. Disconnect and replace the relay valve or turn it upside down to drain water and contaminants before reinstalling. Before disconnecting the air lines, identify and mark them to facilitate reinstallation.

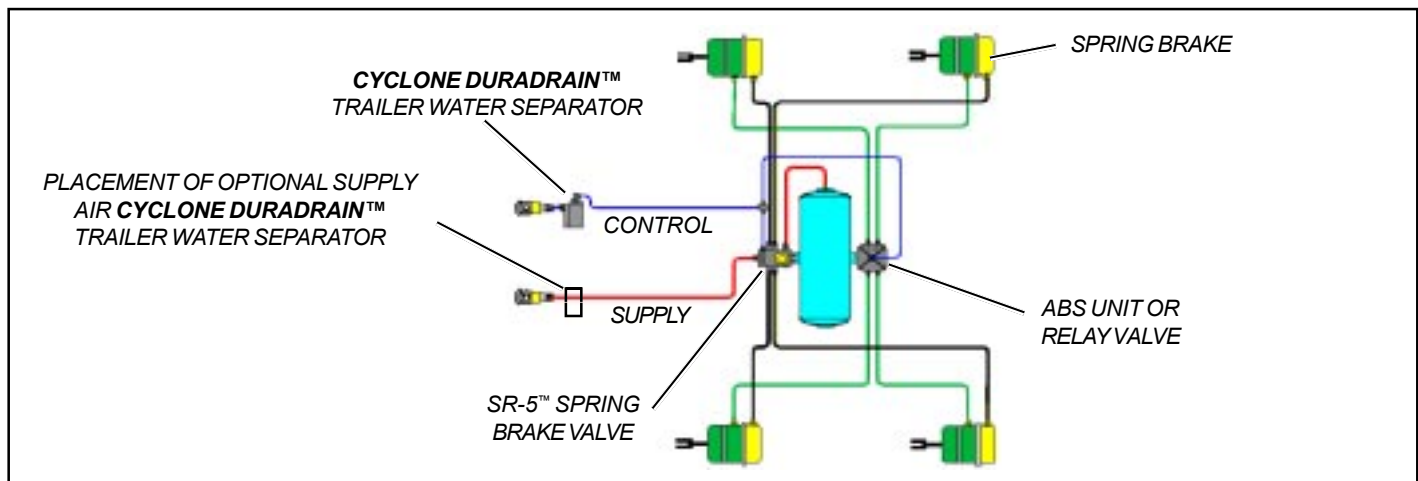

FIGURE 3 - TRAILER SCHEMATIC

4. Connect the air line to the supply and delivery ports of the Cyclone DuraDrain™ trailer water separator.

OPERATIONAL AND LEAKAGE TESTS

Connect the tractor air lines to the trailer to be tested. Block all wheels or hold the vehicle by means other than air brakes.

Supply Line (Emergency)

1. Build tractor and trailer to full system pressure by placing the park control valve and the trailer air supply valve in the charge position.
2. When full system pressure is reached, and the spring brakes are fully released, apply a soap solution to the supply and delivery ports of the Cyclone DuraDrain™ trailer water separator. A 1" bubble in 5 seconds is permissible.

Control Line (Service)

1. Build the tractor and trailer to full system pressure by placing the park control valve and the trailer air supply valve in the charge position.
2. When full system pressure is reached, and the spring brakes are fully released, apply a soap solution to the supply and delivery ports of the Cyclone DuraDrain™ trailer water separator. Apply the brakes and check for leaks. A 1" bubble in 5 seconds is permissible.

Caution: Template included do not resize this document.