



Installation Instructions

XVision® IR Camera Shroud Kit
Piece No. 801469

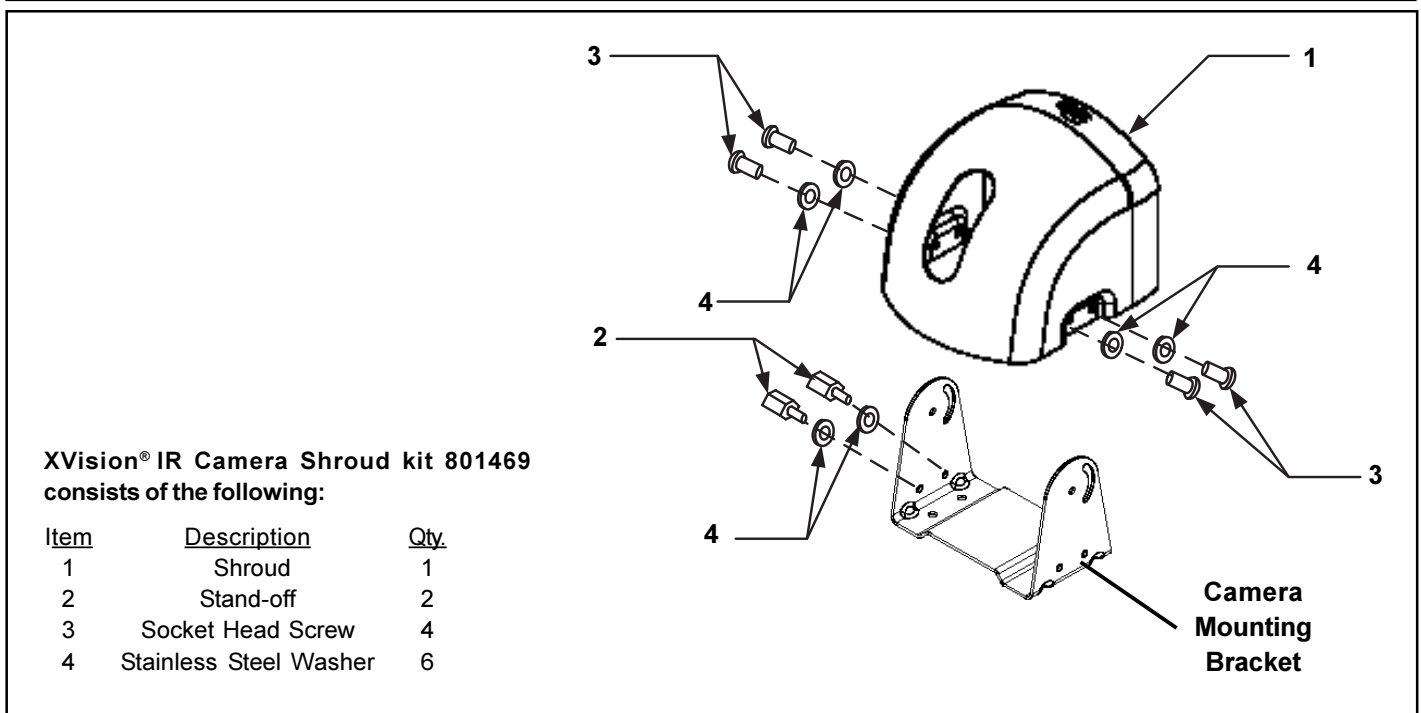

Figure 1 XVision® IR Camera Shroud Kit

DESCRIPTION

This kit contains all of the components necessary to install a shroud on the Bendix® XVision® IR Camera.

IMPORTANT! PLEASE READ AND FOLLOW THESE INSTRUCTIONS TO AVOID PERSONAL INJURY OR DEATH:

When working on or around a vehicle, the following general precautions should be observed at all times.

1. Park the vehicle on a level surface, apply the parking brakes, and always block the wheels.
2. Stop the engine when working around the vehicle.
3. If the vehicle is equipped with air brakes, make certain to drain the air pressure from all reservoirs before beginning ANY work on the vehicle.
4. Following the vehicle manufacturer's recommended procedures, deactivate the electrical system in manner that removes all electrical power from the vehicle.
5. When working in the engine compartment the engine should be shut off. Where circumstances require that the engine be in operation, **EXTREME CAUTION** should be used to prevent personal injury resulting from contact with moving, rotating, leaking, heated, or electrically charged components.

6. Never connect or disconnect a hose or line containing pressure; it may whip. Never remove a component or plug unless you are certain all system pressure has been depleted.
7. Never exceed recommended pressures and always wear safety glasses.
8. Do not attempt to install, remove, disassemble or assemble a component until you have read and thoroughly understand the recommended procedures. Use only the proper tools and observe all precautions pertaining to use of those tools.
9. Use only genuine Bendix replacement parts, components, and kits. Replacement hardware, tubing, hose, fittings, etc. should be of equivalent size, type, and strength as original equipment and be designed specifically for such applications and systems.
10. Components with stripped threads or damaged parts should be replaced rather than repaired. Repairs requiring machining or welding should not be attempted unless specifically approved and stated by the vehicle or component manufacturer.
11. Prior to returning the vehicle to service, make certain all components and systems are restored to their proper operating condition.

INSTALLATION

The XVision® camera is offset in the camera bracket as shown in Figure 2. To ensure proper alignment of the camera window with the shroud opening, the two stand-offs(2) must be installed on the camera mounting bracket before the camera shroud(1) is installed. See Figure 1.

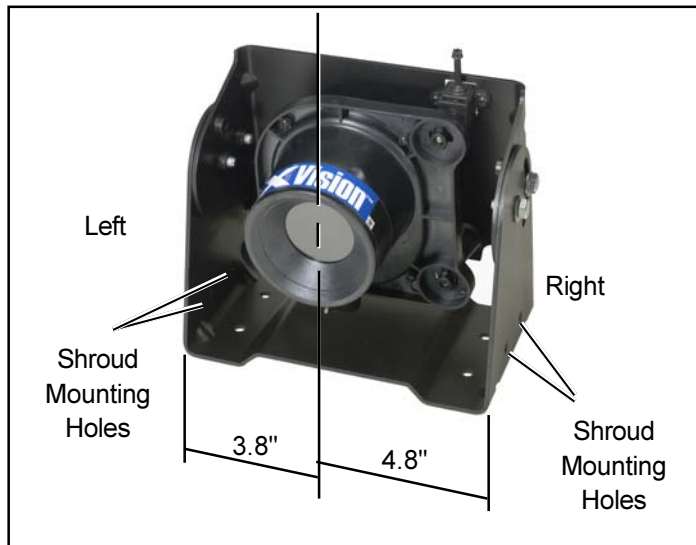

Figure 2 XVision Camera and Bracket Offset

1. When mounting the camera bracket on top of a vehicle in the position shown in Figure 2. Position the bracket with the standoffs up and the adjustment slots toward the back. On the left side of the mounting bracket install two stainless steel washers(4) and stand-offs(2). Tighten to approximately 90 in-lbs.

If positioning the mounting bracket on the vehicle in a position different from Figure 2, identify the proper location of the stand-offs before mounting them to the bracket. Measure from the center of the camera window to the mounting bracket standoff to determine the offset location. For example, if the camera bracket is installed upside-down in the mounting bracket the stand-offs would be added to the right side of the bracket to ensure proper centering of the shroud.

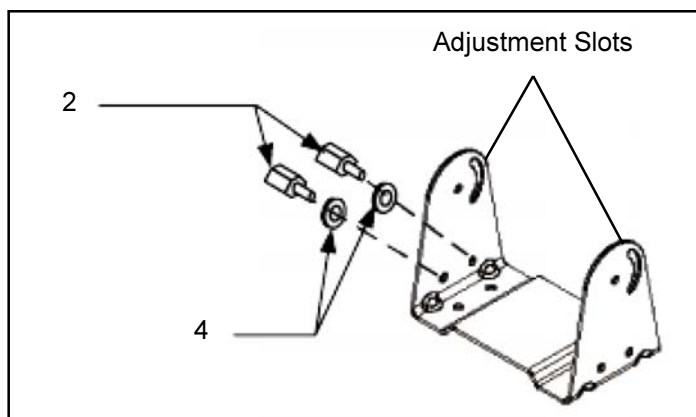

Figure 3 XVision® IR Camera Shroud

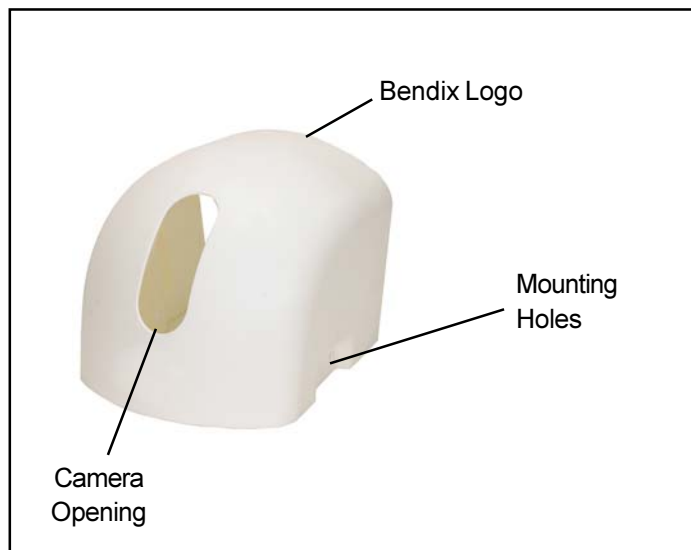

Figure 4 XVision® IR Camera Shroud

2. Position the camera shroud(1) over the camera with the Bendix logo positioned upward when used as shown in figure 2. See Figure 4.
3. Secure the shroud(1) with the washers(4) and socket head screws(3). Tighten to approximately 90 in-lbs.