

# UP2DATE

## KNORR-BREMSE TRUCKSERVICES "BRAKE PARTS FINDER" APP

Renaming and expansion of the original Brake Pad and Brake Disc Finder App.

The original "Brake Pad and Disc Finder" has been renamed and its portfolio expanded to include Drum Brake Linings. An additional new feature links all results directly to their related page in the TruckServices Customer Portal.

The original TruckServices "Brake Pad and Disc Finder" App is now known as the "Brake Parts Finder". Its product range includes Brake Pads, Brake Discs and Brake Linings. With the same look and feel, not only can you quickly and easily find the recommended Knorr-Bremse serviceable brake wear parts for your vehicle, but with just one click on the resulting part number, go directly to its detailed page in the TruckServices online Customer Portal.

App start page



### General Navigation:

- ① From the launch page click the "START" button to begin.
- ② Choose the category "PADS", "DISCS" or "LININGS".

**Note:** Each category's navigation varies slightly (see page 2 for exact details). However, navigation on the final page is the same:

- Ⓐ Short-cut switching between product categories (Pads, Discs, Linings) or back to the App Start page.
- Ⓑ The "Back Arrow" takes you back to the previous level.
- Ⓒ Vehicle model selection list.
- Ⓓ Results area, showing recommended Knorr-Bremse part numbers, each with a direct link to its page in the TruckServices online Customer Portal.
- Ⓔ Opens an info pop-up window of related documentation.
- Ⓕ Links directly to the TruckServices Customer Portal home page.
- Ⓖ Links directly to the TruckServices website.

### At a glance

- › Online version, no download required
- › Quick and easy to use across all devices
- › Direct link to products Customer Portal page
- › Smart-phone friendly
- › Always the latest version at hand

Example: Final page navigation

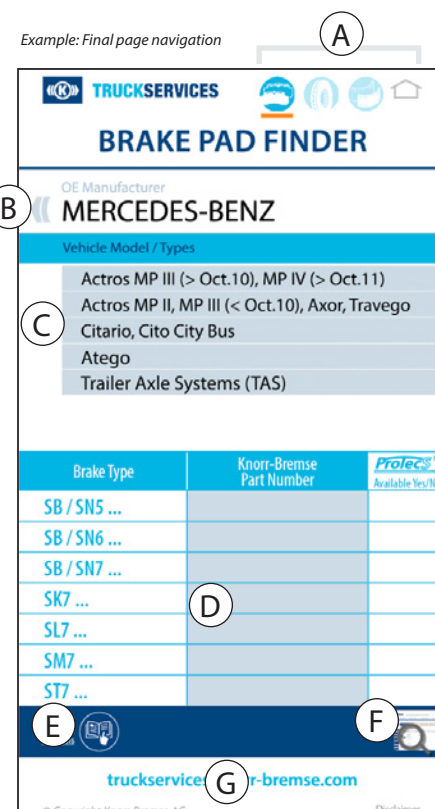

## Brake Pad Finder (continued from page 1):

- ③ Select from the list of vehicle manufacturers.
- ④ Select vehicle model (if available).
- ⑤ The Brake Pad Finder displays the recommended Knorr-Bremse Brake Pad Kit per pneumatic Disc Brake application. If ProtecS® equipped, a ProtecS® indicator will be shown to the right of the part number. The info field shows additional information, if available.

**Note:** each part number links directly to its detailed page in the TruckServices online Customer Portal.

## Brake Disc Finder (continued from page 1):

- ③ Select the required vehicle category (Truck, Bus, Trailer or Light Commercial Vehicle (LCV)).
- ④ Select from the list of vehicle manufacturers.
- ⑤ Select vehicle model (if available).
- ⑥ The Brake Disc Finder will display the resulting Knorr-Bremse Brake Discs. Use the OE number, its installation location and manufacturing year to find the recommended Knorr-Bremse Brake Disc. Additionally you can see in the last column if the Brake Disc Measuring Gauge K146719K50 is compatible.
- ⑦ Chosen vehicle category, when clicked returns you back to vehicle category page ③.

**Note:** each part number links directly to its detailed page in the TruckServices online Customer Portal.

## Brake Linings Finder (continued from page 1):

- ③ Select from the list of vehicle manufacturers
- ④ Select vehicle model (if available)
- ⑤ The Brake Linings Finder displays the recommended Knorr-Bremse Brake Linings Kit, WVA, Year of Manufacture and axle (front/rear).

**Note:** each part number links directly to its detailed page in the TruckServices online Customer Portal.

The Brake Parts Finder App can be found online on the Customer Portal website [mytruckservices.knorr-bremse.com](https://mytruckservices.knorr-bremse.com) or directly from [here](#).

Brake Pad Finder example

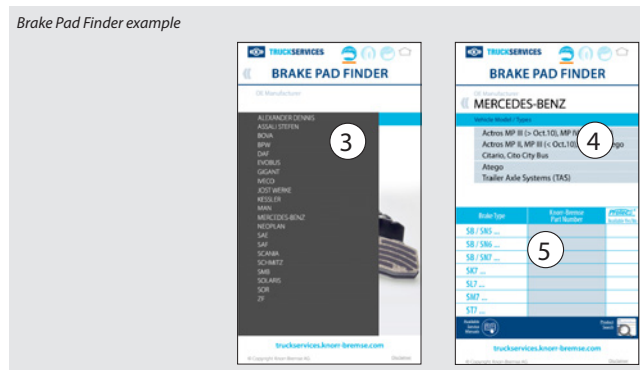

Brake Disc Finder example

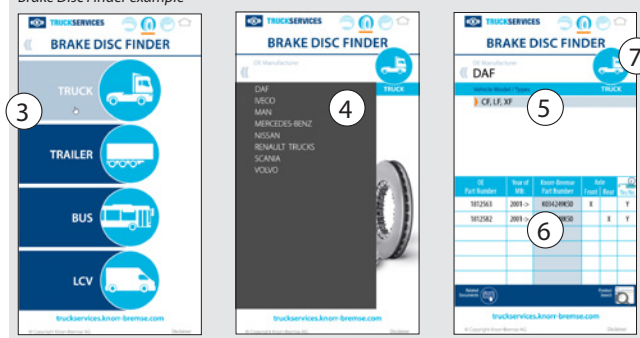

Brake Linings Finder example

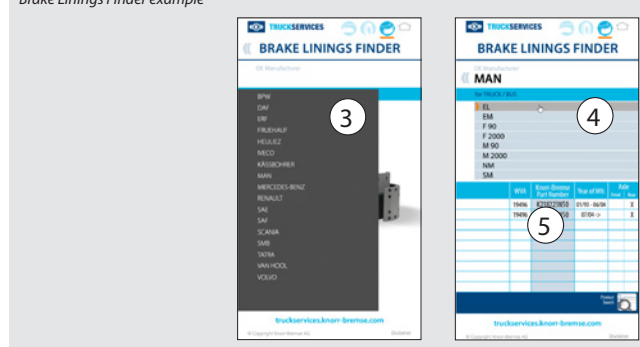

Up-to-date information on our products can be found on our website [truckservices.knorr-bremse.com](https://truckservices.knorr-bremse.com)

## KEEP IT RUNNING



**Knorr-Bremse Systems for Commercial Vehicles**  
Moosacher Strasse 80 | 80809 Munich | Germany  
Tel: +49 89 3547-0  
Fax: +49 89 3547-2767  
[truckservices.knorr-bremse.com](https://truckservices.knorr-bremse.com)

### Note

All information is subject to change. A printed version of this document may therefore not correspond to the latest revision. To obtain the latest version, please visit our website [truckservices.knorr-bremse.com](https://truckservices.knorr-bremse.com) or contact a Knorr-Bremse representative in your area.

If service work is carried out on a vehicle based on information provided herein, it is the responsibility of the workshop to ensure the vehicle is fully tested and in full functional order before the vehicle is returned into service. Knorr-Bremse accepts no liability for problems caused as a result of appropriate tests not being carried out.

### Copyright © Knorr-Bremse AG

All rights reserved, including industrial property rights applications. Knorr-Bremse AG retains any power of disposal, such as for copying and transferring.

### Disclaimer

The information contained herein is intended for the exclusive use of trained persons within the commercial vehicle industry, and must not be passed on to any third party. All recommendations regarding products and their servicing or usage are with reference to Knorr-Bremse products and should not be considered applicable to products from other manufacturers. This information does not purport to be all-inclusive and no responsibility is assumed as a result of its use. We cannot accept any liability nor offer any guarantee regarding data accuracy, completeness or timeliness. The information does not represent any guarantee or ensured characteristics of the Products or Systems described. No liability can be accepted based on the information, its use, recommendations or advice provided. In no event may we be held liable for any damage or loss except in the case of wilful intent or gross negligence on our part, or if any mandatory legal provisions apply. This disclaimer is an English translation of a German text, which should be referred to for all legal purposes. Any legal disputes arising from the use of this information shall be subject to German law.