



# Installation Instructions

PuraGuard Maintenance Kit  
- 5006788  
PuraGuard Rebuild Kit  
- 5006789

## PURAGUARD SYSTEM FILTER

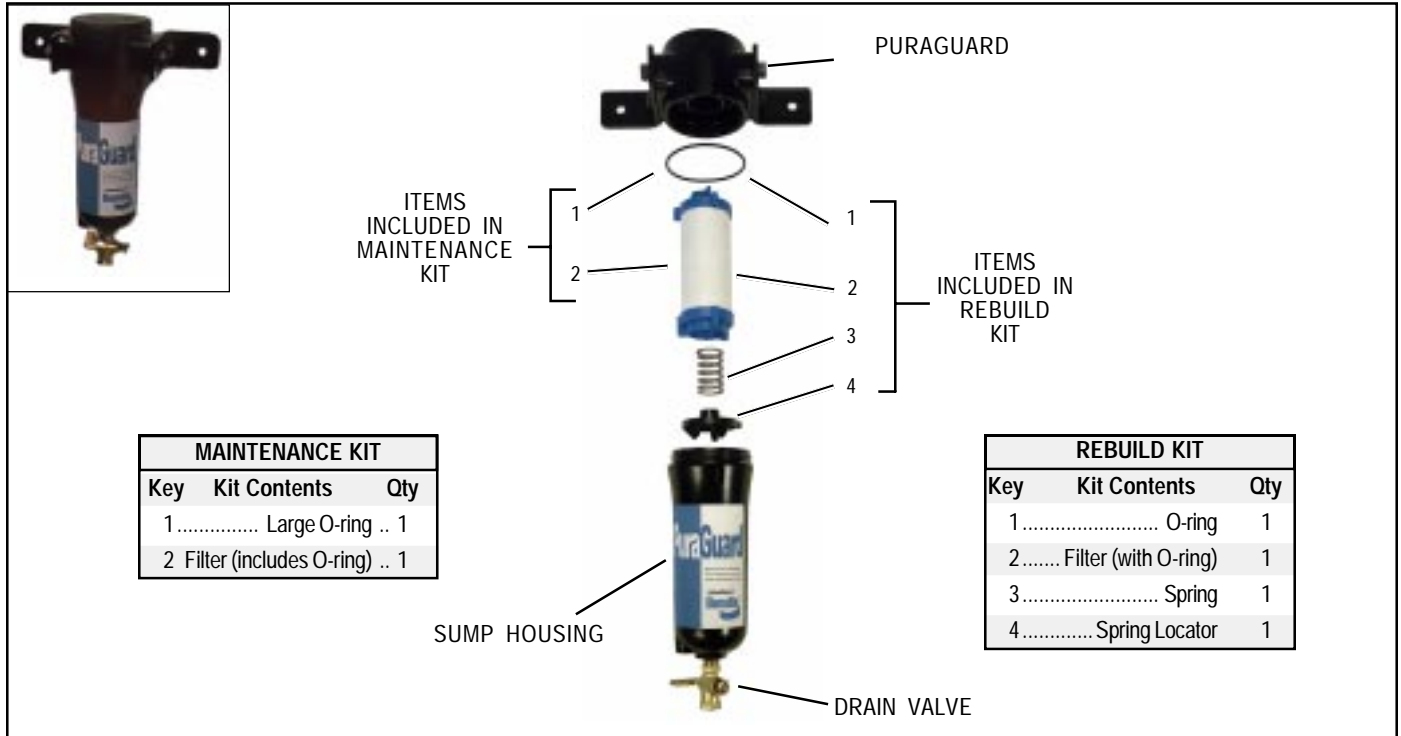

FIGURE 1 - MAINTENANCE KITS

### **IMPORTANT! PLEASE READ AND FOLLOW THESE INSTRUCTIONS TO AVOID PERSONAL INJURY OR DEATH:**

When working on or around a vehicle, the following general precautions should be observed at all times.

1. Park the vehicle on a level surface, apply the parking brakes, and always block the wheels.
2. Stop the engine when working around the vehicle.
3. If the vehicle is equipped with air brakes, make certain to drain the air pressure from all reservoirs before beginning ANY work on the vehicle.
4. Following the vehicle manufacturer's recommended procedures, deactivate the electrical system in manner that removes all electrical power from the vehicle.
5. When working in the engine compartment the engine should be shut off. Where circumstances require that the engine be in operation, **EXTREME CAUTION** should be used to prevent personal injury resulting from contact with moving, rotating, leaking, heated, or electrically charged components.
6. Never connect or disconnect a hose or line containing pressure; it may whip. Never remove a

component or plug unless you are certain all system pressure has been depleted.

7. Never exceed recommended pressures and always wear safety glasses.
8. Do not attempt to install, remove, disassemble or assemble a component until you have read and thoroughly understand the recommended procedures. Use only the proper tools and observe all precautions pertaining to use of those tools.
9. Use only genuine Bendix replacement parts, components, and kits. Replacement hardware, tubing, hose, fittings, etc. should be of equivalent size, type, and strength as original equipment and be designed specifically for such applications and systems.
10. Components with stripped threads or damaged parts should be replaced rather than repaired. Repairs requiring machining or welding should not be attempted unless specifically approved and stated by the vehicle or component manufacturer.
11. Prior to returning the vehicle to service, make certain all components and systems are restored to their proper operating condition.

For further maintenance information see Service Data Sheet SD-08-187.

## VEHICLE PREPARATION

1. Park the vehicle on a level surface and prevent movement by means other than the brakes.
2. Drain all reservoirs to 0 p.s.i.
3. Drain the contents of the Sump into a suitable container for disposal and then re-close the drain valve.
4. Using detergent and water, clean the exterior of the PuraGuard of road grime etc.

See *Important General Precautions* at the end of these instructions.

## DISASSEMBLY AND CLEANING (see Figure 1)

1. Unscrew the Sump Housing of the PuraGuard. If necessary, use a strap wrench to assist this process.
2. Remove and discard the filter and o-ring.

If only installing the maintenance kit go to *Inspection* section below.

3. Using long-nose pliers, carefully remove and discard the spring and spring locator inside the Sump Housing.
4. Using detergent and water or other suitable solvent, clean inside the Sump Housing.

## INSPECTION

1. Inspect the PuraGuard for broken or missing parts. Replace as necessary.
2. Inspect the drain valve for any build-up that could impair its function. Clean as necessary.

## ASSEMBLY (see Figure 1)

1. Install the replacement o-ring into the channel in the head of the PuraGuard.

If only installing the maintenance kit, go to item 4 below.

2. Install the Spring onto the Spring Locator.
3. Using long-nose pliers, install the Spring Locator and Spring assembly into the Sump.
4. Insert the replacement filter (guide lands uppermost) into the Sump with its base resting on the Spring.
5. Coat the threads of the Sump Housing using barium or lithium grease. Sufficient torque to install the Sump will be produced by turning the Housing by hand until fully hand-tight. Take care not to damage the large O-ring when installing the Sump Housing.

## OPERATIONAL TEST

Build the air system to governor cutout. Shut off the engine. Using a soap solution, check all hoses and fittings leading to and from the PuraGuard for leakage and integrity. Repair any excessive leaks - exceeding a 1 inch bubble in 5 seconds - before restoring vehicle to service.

