



Installation Instructions

IR Camera Window and Heater Replacement Kit Piece Nos. 5010192 & 5010193 for XVision® IR Camera

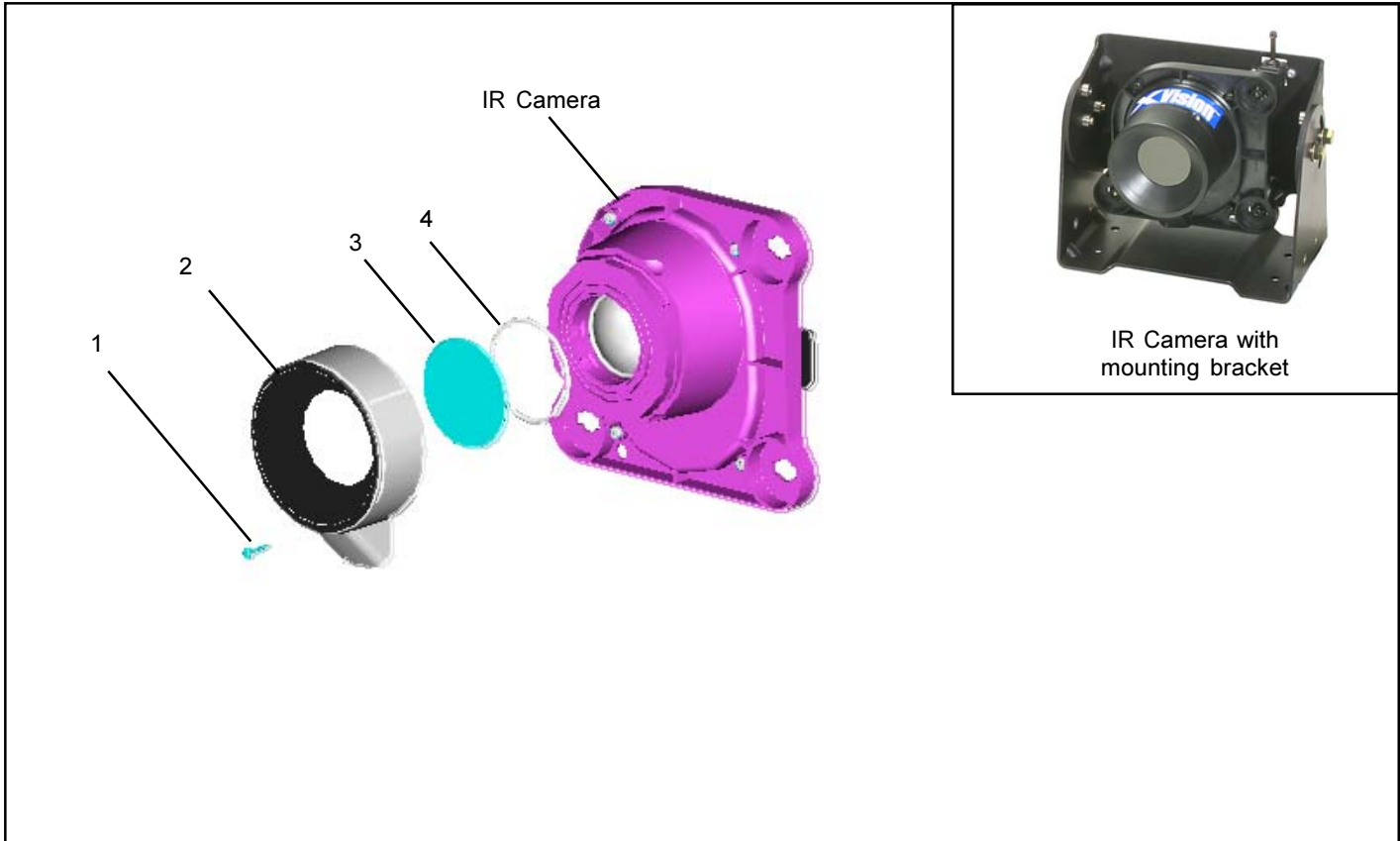

Figure 1 XVision® IR Camera Kits

The XVision® IR Camera Window Replacement Kit piece number 5010192 consists of the following:

Item No.	Description	Qty.
1	Nylon Rivet	1
3	Camera Window	1
4	O-ring	1
NS	Cleaning Brush	1

The XVision IR Camera Heater Replacement Kit piece number 5010193 consists of the following:

Item No.	Description	Qty.
1	Nylon Rivet	1
2	Window Heater	1

NS = Not shown

DESCRIPTION

These instructions are used for installation of the IR Camera Window Replacement and Heater Replacement Kits.

IMPORTANT! PLEASE READ AND FOLLOW THESE INSTRUCTIONS TO AVOID PERSONAL INJURY OR DEATH:

When working on or around a vehicle, the following general precautions should be observed at all times.

1. Park the vehicle on a level surface, apply the parking brakes, and always block the wheels.
2. Stop the engine when working around the vehicle.
3. If the vehicle is equipped with air brakes, make certain to drain the air pressure from all reservoirs before beginning ANY work on the vehicle.
4. Following the vehicle manufacturer's recommended procedures, deactivate the electrical system in manner that removes all electrical power from the vehicle.

5. When working in the engine compartment the engine should be shut off. Where circumstances require that the engine be in operation, **EXTREME CAUTION** should be used to prevent personal injury resulting from contact with moving, rotating, leaking, heated, or electrically charged components.
6. Never connect or disconnect a hose or line containing pressure; it may whip. Never remove a component or plug unless you are certain all system pressure has been depleted.
7. Never exceed recommended pressures and always wear safety glasses.
8. Do not attempt to install, remove, disassemble or assemble a component until you have read and thoroughly understand the recommended procedures. Use only the proper tools and observe all precautions pertaining to use of those tools.
9. Use only genuine Bendix® replacement parts, components, and kits. Replacement hardware, tubing, hose, fittings, etc. should be of equivalent size, type, and strength as original equipment and be designed specifically for such applications and systems.
10. Components with stripped threads or damaged parts should be replaced rather than repaired. Repairs requiring machining or welding should not be attempted unless specifically approved and stated by the vehicle or component manufacturer.
11. Prior to returning the vehicle to service, make certain all components and systems are restored to their proper operating condition.

DISASSEMBLY

For ease of installation the camera can be removed from the mounting bracket for servicing. Refer to figure 1 during the disassembly and assembly process. Note: If the camera window is broken use caution to prevent injury.

1. Clean the exterior of the IR camera to prevent dirt from entering the housing during servicing.
2. Remove the center pin and the nylon rivet(1) that secures the window heater(2) to the camera.
3. Gently rotate the heater counter-clockwise approximately 30° and pull it away from the camera. Use caution to prevent the camera window(3) and o-ring(4) from falling out of the camera. If installing the window heater kit skip steps 4 and 5 and go to the assembly section.
4. Remove the camera window(3) and o-ring(4) from the camera body.
5. Clean the camera housing with the cleaning brush provided.

ASSEMBLY

Use the contents of the kit when servicing.

1. Install o-ring(4) in the camera housing
2. Place the camera window(3) over the o-ring(4).
3. Hold the window and o-ring in place and install the window heater(2) on the camera housing body. While ensuring the window is centered, gently turn the window heater in a clockwise motion approximately 30°.
4. Install the nylon rivet(1) and secure with the center pin.