

# Installation Instructions



## ADAPTER PLATE KIT

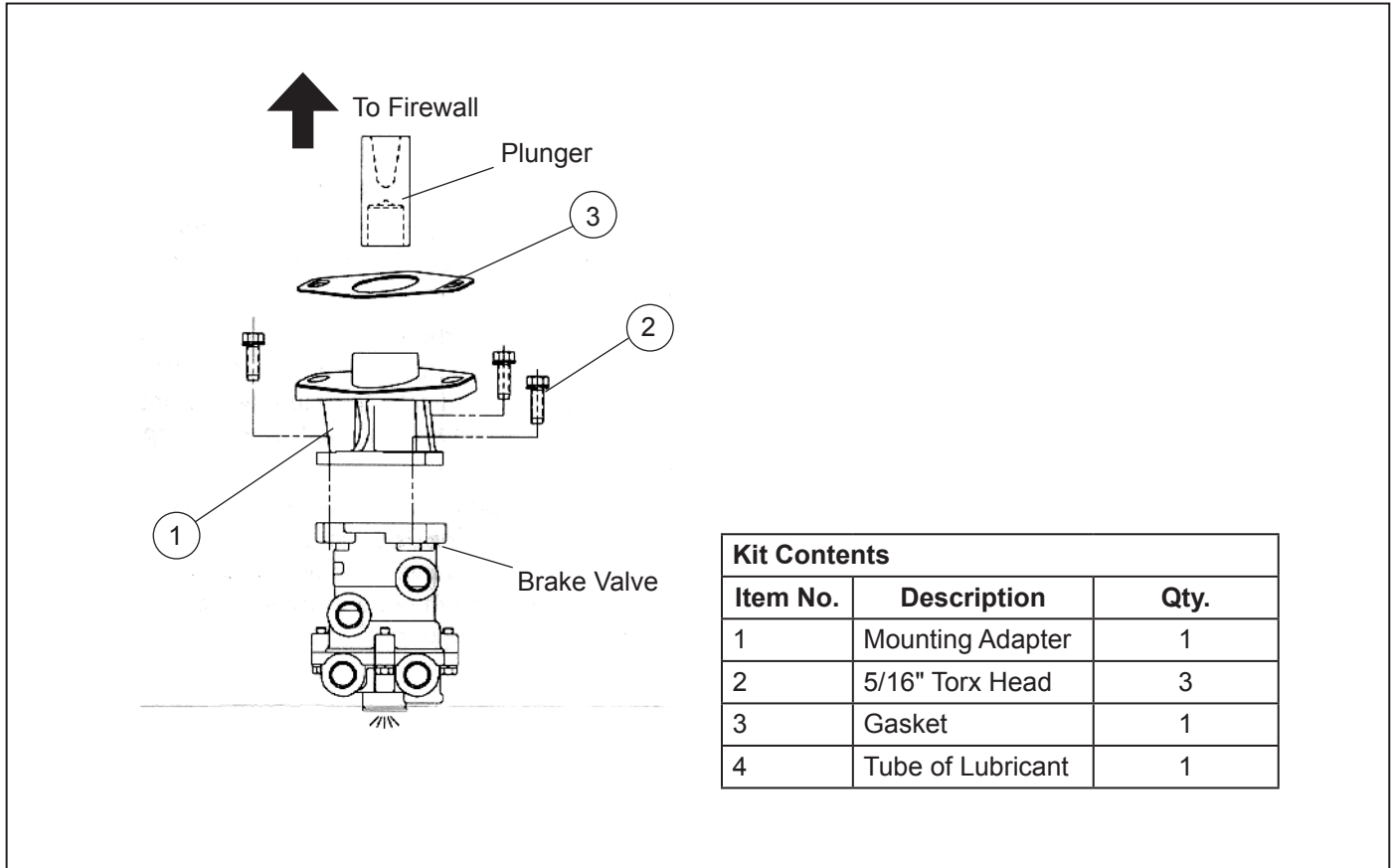

Figure 1 – Brake Valve with Adapter

### REMOVAL

1. Park the vehicle on a level surface and block the wheels.
2. Drain the air pressure from all vehicle reservoirs.
3. Remove and retain the mounting hardware which secures the brake valve assembly to the vehicle firewall.
4. Remove and discard the three hex head cap screws (2) that secure the mounting adapter to the brake valve.
5. Remove the mounting adapter and plunger from the brake valve. Remove and retain the plunger and discard the mounting adapter.

### CLEANING AND INSPECTION

1. Scrape any gasket material from the adapter mounting surface of the firewall.
2. Use mineral spirits or an equivalent solvent to clean all metal parts.
3. Inspect the brake valve for severe corrosion, pitting, or cracks. Replace as necessary. Superficial corrosion and/or pitting is acceptable.

### INSTALLATION

Use all components contained in this kit.

1. Secure the mounting adapter (1) to the brake valve using the three hex head cap screws (2). Torque to 80-120 in-lbs.
2. Using the lubricant (4) provided, lubricate the external surface of the plunger where the plunger contacts the mounting adapter. Lubricate the plunger and insert into the mounting adapter bore with the conical opening pointing up.
3. Place the mounting gasket (3) on the mounting adapter (1). Align the brake pedal rod with the plunger opening. Secure the brake valve assembly and gasket to the firewall using the removed mounting hardware. Torque to 150-180 in-lbs.



## GENERAL SAFETY GUIDELINES

**WARNING! PLEASE READ AND FOLLOW THESE INSTRUCTIONS**

**TO AVOID PERSONAL INJURY OR DEATH:**

When working on or around a vehicle, the following guidelines should be observed **AT ALL TIMES**:

- ▲ Park the vehicle on a level surface, apply the parking brakes and always block the wheels. Always wear personal protection equipment.
- ▲ Stop the engine and remove the ignition key when working under or around the vehicle. When working in the engine compartment, the engine should be shut off and the ignition key should be removed. Where circumstances require that the engine be in operation, **EXTREME CAUTION** should be used to prevent personal injury resulting from contact with moving, rotating, leaking, heated or electrically-charged components.
- ▲ Do not attempt to install, remove, disassemble or assemble a component until you have read, and thoroughly understand, the recommended procedures. Use only the proper tools and observe all precautions pertaining to use of those tools.
- ▲ If the work is being performed on the vehicle's air brake system, or any auxiliary pressurized air systems, make certain to drain the air pressure from all reservoirs before beginning **ANY** work on the vehicle. If the vehicle is equipped with a Bendix® AD-IS® air dryer system, a Bendix® DRM™ dryer reservoir module, or a Bendix® AD-9si® air dryer, be sure to drain the purge reservoir.
- ▲ Following the vehicle manufacturer's recommended procedures, deactivate the electrical system in a manner that safely removes all electrical power from the vehicle.
- ▲ Never exceed manufacturer's recommended pressures.
- ▲ Never connect or disconnect a hose or line containing pressure; it may whip and/or cause hazardous airborne dust and dirt particles. Wear eye protection. Slowly open connections with care, and verify that no pressure is present. Never remove a component or plug unless you are certain all system pressure has been depleted.
- ▲ Use only genuine Bendix® brand replacement parts, components and kits. Replacement hardware, tubing, hose, fittings, wiring, etc. must be of equivalent size, type and strength as original equipment and be designed specifically for such applications and systems.
- ▲ Components with stripped threads or damaged parts should be replaced rather than repaired. Do not attempt repairs requiring machining or welding unless specifically stated and approved by the vehicle and component manufacturer.
- ▲ Prior to returning the vehicle to service, make certain all components and systems are restored to their proper operating condition.
- ▲ For vehicles with Automatic Traction Control (ATC), the ATC function must be disabled (ATC indicator lamp should be ON) prior to performing any vehicle maintenance where one or more wheels on a drive axle are lifted off the ground and moving.
- ▲ The power **MUST** be temporarily disconnected from the radar sensor whenever any tests **USING A DYNAMOMETER** are conducted on a vehicle equipped with a Bendix® Wingman® system.
- ▲ You should consult the vehicle manufacturer's operating and service manuals, and any related literature, in conjunction with the Guidelines above.

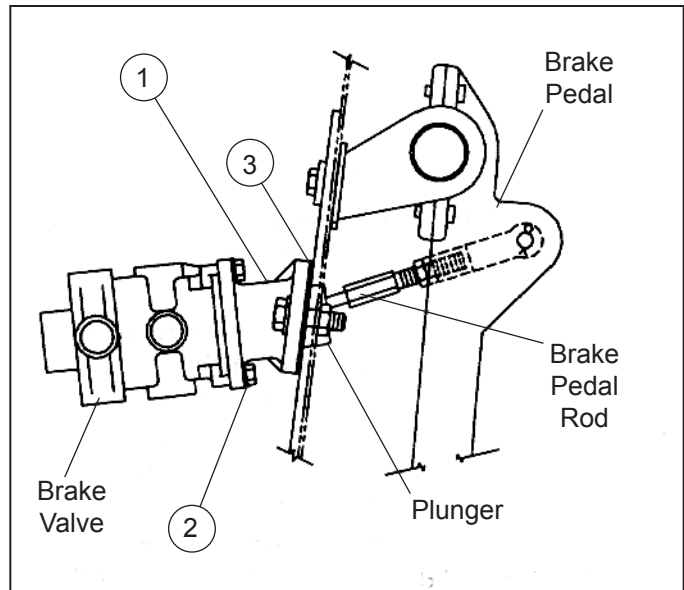

Figure 2 – Vehicle Installation

**Trucking moves fast. Move faster.**

**Knowledge Dock™**

• BLOGS • PODCASTS • VIDEOS • 24/7/365

[ [knowledge-dock.com](http://knowledge-dock.com) ]



### Log-on and Learn from the Best

On-line training that's available when you are –24/7/365.  
Visit [brake-school.com](http://brake-school.com).