

UP2DATE

TOOL COMPONENTS FOR BRAKE PROFESSIONALS

Tool sets to renew the most used components of the Knorr-Bremse Disc Brake Tool Case K158880K50

Knorr-Bremse Tool Case K158880K50 contains all the special tools required for professional repair of Knorr-Bremse Air Disc Brake types SB6/SN6/SB7/SN7/SK7/SM/SL7/ST7 and SyD7.

During demanding service work, a tool can sometimes get lost or damaged when in use. To ensure that you can continue to carry out the service steps involved in servicing Knorr-Bremse pneumatic disc brakes as described in the service manuals, Knorr-Bremse now offers three new tool component sets containing the most stressed components, which you can use to exchange or replace individual tools in Knorr-Bremse tool kit K158880K50.

You will find an overview of these on the next page.

At a glance

- › Workshop solutions inspired by the market: Three tool component sets for restocking.
- › Developed in cooperation with leading manufacturers of special tools
- › Easier, safer, faster and more cost-effective maintenance and repairs
- › Continuous expansion of the tool program

Set 1



Set 2



Set 3



OVERVIEW OF THE TOOL COMPONENT SETS

Tool sets to renew the most used components of the Knorr-Bremse Disc Brake Tool Case K158880K50

Set	Knorr-Bremse Part Number	Content	Tool Component Numbers
1	K253725N50	Spindle, Nut, Bearing	TB01, TB17, TB18
2	K171773N50	Fork	TB03
3	K253727N50	Grooving Tool, Pressure Sleeves, Guide Sleeve, Pressure piece for pressure sleeve	TB05, TB16, TB21, TB23

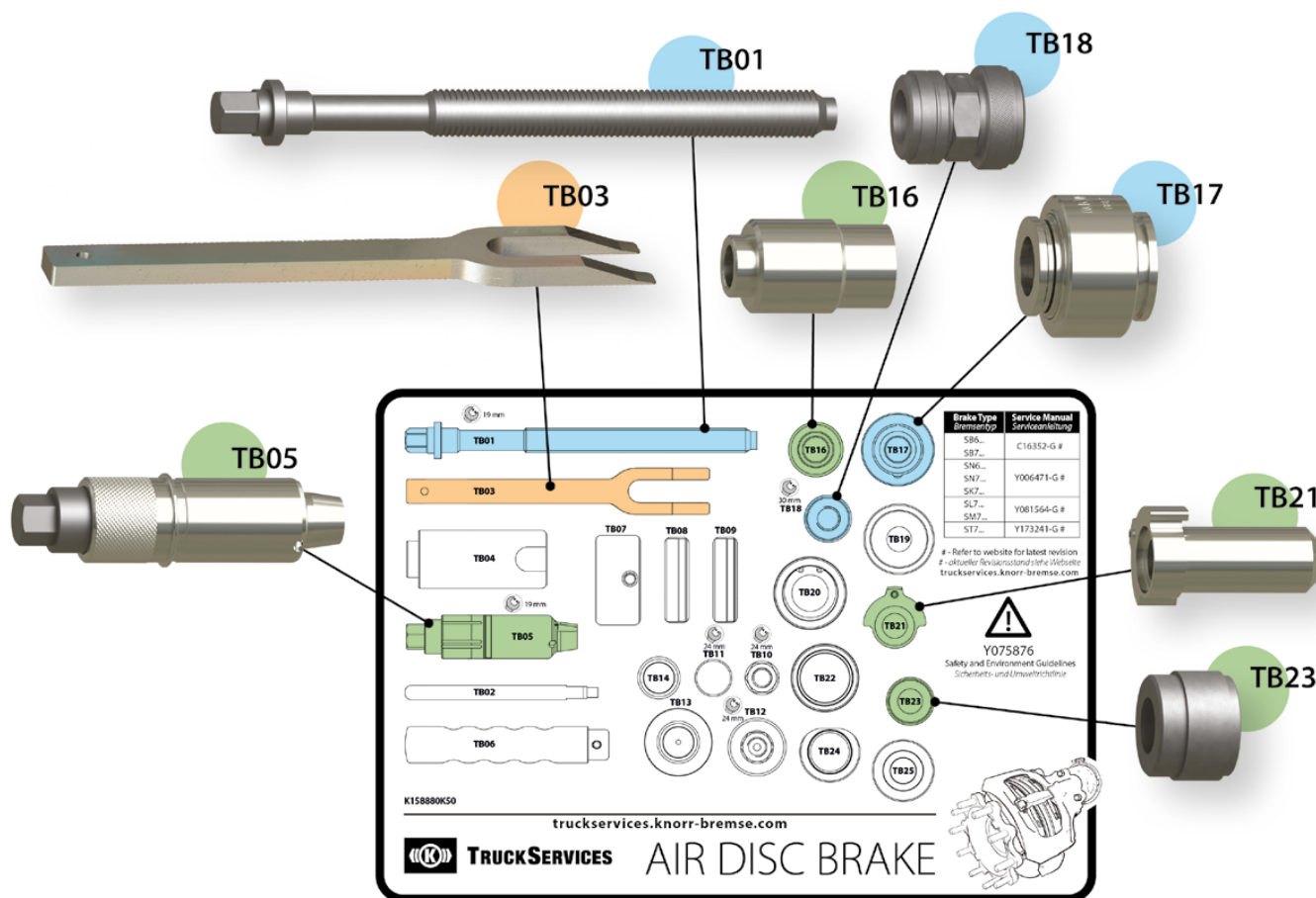

Learn more about Knorr-Bremse specialist tools here:

SPECIAL TOOLS & AUXILIARY TOOLS - COMPREHENSIVE SOLUTIONS FROM KNORR-BREMSE: UP2DATE Y322340



↑
or click QR code
to download from
website

KEEP IT RUNNING

Up-to-date information on our products can be
found on our website truckservices.knorr-bremse.com



Knorr-Bremse Systems for Commercial Vehicles

Moosacher Strasse 80 | 80809 Munich | Germany

Tel: +49 89 3547-0

Fax: +49 89 3547-2767

truckservices.knorr-bremse.com

Note

All information is subject to change. A printed version of this document may therefore not correspond to the latest revision. To obtain the latest version, please visit our website truckservices.knorr-bremse.com or contact a Knorr-Bremse representative in your area.

If service work is carried out on a vehicle based on information provided herein, it is the responsibility of the workshop to ensure the vehicle is fully tested and in full functional order before the vehicle is returned into service. Knorr-Bremse accepts no liability for problems caused as a result of appropriate tests not being carried out.

Copyright © Knorr-Bremse AG

All rights reserved, including industrial property rights applications. Knorr-Bremse AG retains any power of disposal, such as for copying and transferring.

Disclaimer

The information contained herein is intended for the exclusive use of trained persons within the commercial vehicle industry, and must not be passed on to any third party. All recommendations regarding products and their servicing or usage are with reference to Knorr-Bremse products and should not be considered applicable to products from other manufacturers. This information does not purport to be all-inclusive and no responsibility is assumed as a result of its use. We cannot accept any liability nor offer any guarantee regarding data accuracy, completeness or timeliness. The information does not represent any guarantee or ensured characteristics of the Products or Systems described. No liability can be accepted based on the information, its use, recommendations or advice provided. In no event may we be held liable for any damage or loss except in the case of wilful intent or gross negligence on our part, or if any mandatory legal provisions apply. This disclaimer is an English translation of a German text, which should be referred to for all legal purposes. Any legal disputes arising from the use of this information shall be subject to German law.