

Installation Instructions

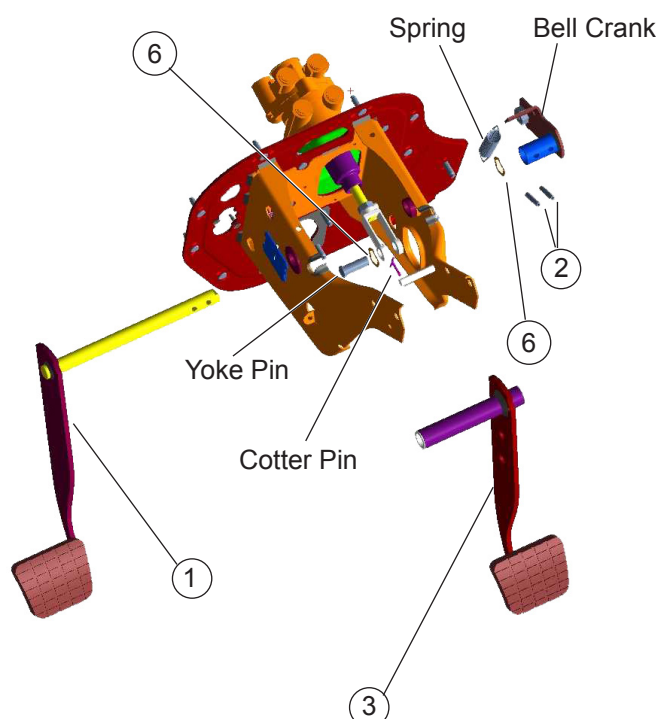

BRAKE PEDAL AND CLUTCH PEDAL REPLACEMENT KITS



Standard Transmission

Kit Piece No. 5008921 (for vehicles with Hydromax® power brake system and air braked vehicles from year 2000 through 2006) consists of:

Item No.	Description	Qty.
2	Roll Pins	2
3	Brake Pedal Assembly	1

Kit Piece No. 5008922 (for Hydromax and air-braked vehicles from year 2000 through 2006) consists of:

Item No.	Description	Qty.
2	Roll Pins	2
3	Brake Pedal w/Cover	1

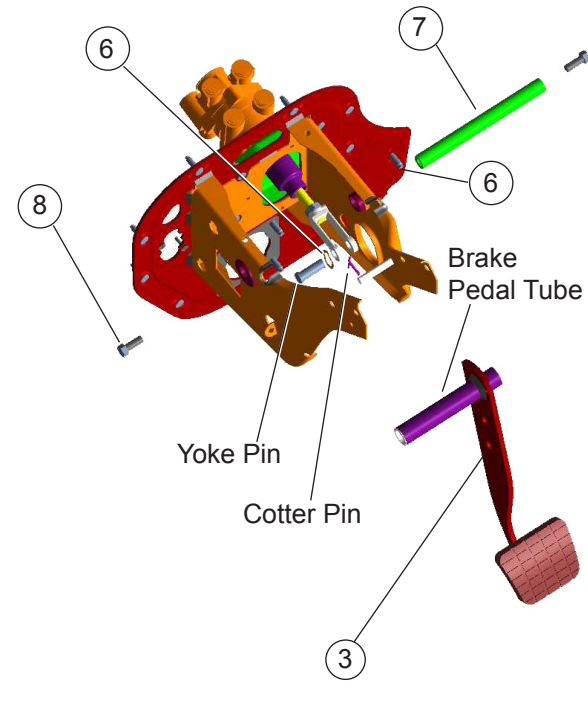

Automatic Transmission

Kit Piece No. 5008923 consists of:

Item No.	Description	Qty.
1	Clutch Pedal	1
2	Roll Pins	2

Kit Piece No. 5008924 consists of:

Item No.	Description	Qty.
1	Clutch Pedal w/Cover	1
2	Roll Pins	2

Kit Piece No. 5020631 consists of:

Item No.	Description	Qty.
6	Wave Washer	1
7	Pivot Shaft	1
8	3/8" Flange Screw	2

Figure 1 – Brake Pedal and Clutch Pedal Kits

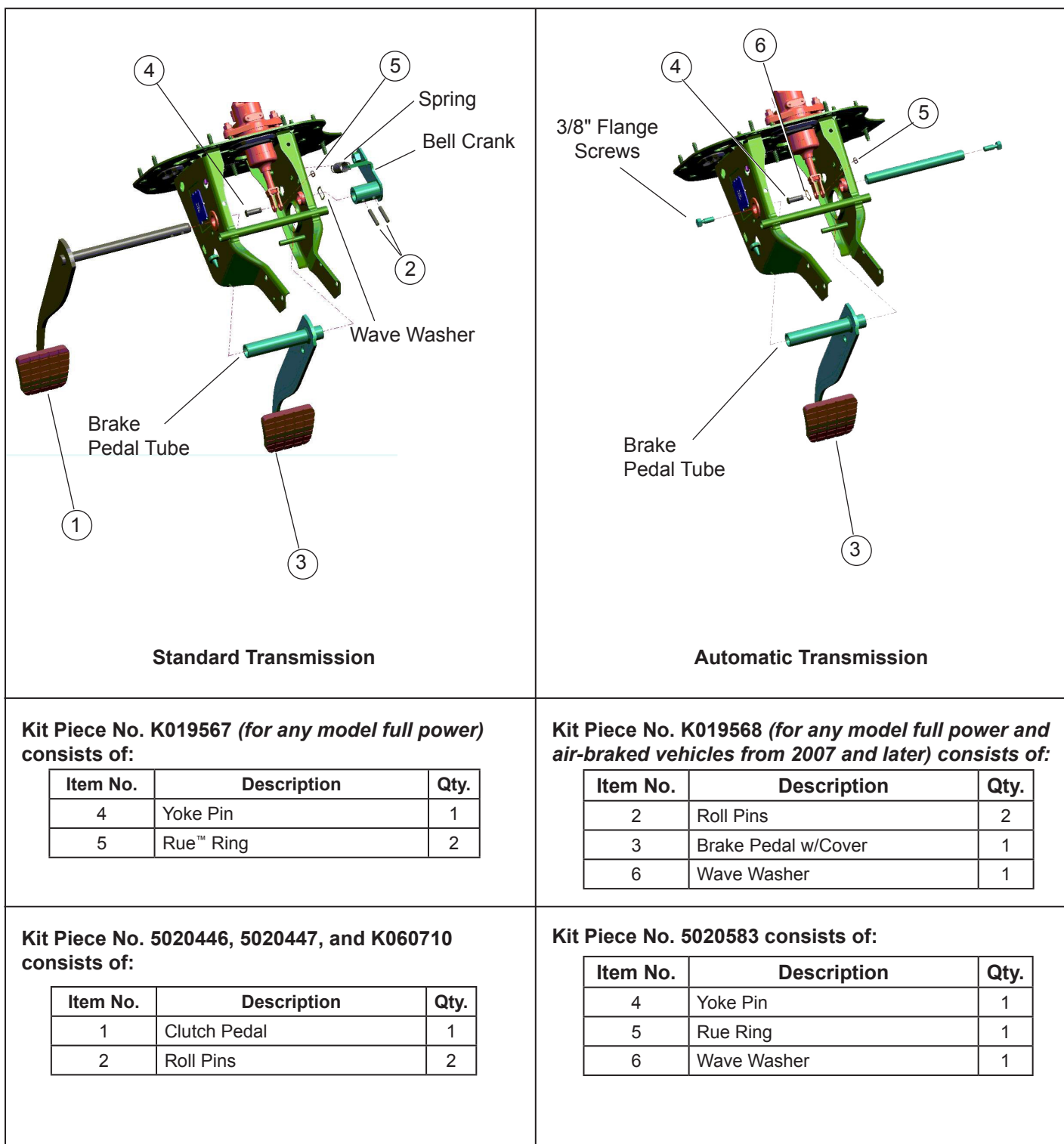

Figure 2 – Brake Pedal, Clutch Pedal, Yoke Pin, and Roll Pin Kits

DESCRIPTION

This kit contains all of the components necessary to replace the brake pedal (3), clutch pedal (1), yoke pins (4), or roll pins (2). The components contained in the various kits are identified throughout this document.

Where available, always use the service procedures presented in the vehicle manufacturer's service manual. The procedures presented here are a general guide, but note that specific requirements may vary.



GENERAL SAFETY GUIDELINES

WARNING! PLEASE READ AND FOLLOW THESE INSTRUCTIONS

TO AVOID PERSONAL INJURY OR DEATH:

When working on or around a vehicle, the following guidelines should be observed AT ALL TIMES:

- ▲ Park the vehicle on a level surface, apply the parking brakes and always block the wheels. Always wear personal protection equipment.
- ▲ Stop the engine and remove the ignition key when working under or around the vehicle. When working in the engine compartment, the engine should be shut off and the ignition key should be removed. Where circumstances require that the engine be in operation, **EXTREME CAUTION** should be used to prevent personal injury resulting from contact with moving, rotating, leaking, heated or electrically-charged components.
- ▲ Do not attempt to install, remove, disassemble or assemble a component until you have read, and thoroughly understand, the recommended procedures. Use only the proper tools and observe all precautions pertaining to use of those tools.
- ▲ If the work is being performed on the vehicle's air brake system, or any auxiliary pressurized air systems, make certain to drain the air pressure from all reservoirs before beginning **ANY** work on the vehicle. If the vehicle is equipped with a Bendix® AD-IS® air dryer system, a Bendix® DRM™ dryer reservoir module, or a Bendix® AD-9si® air dryer, be sure to drain the purge reservoir.
- ▲ Following the vehicle manufacturer's recommended procedures, deactivate the electrical system in a manner that safely removes all electrical power from the vehicle.
- ▲ Never exceed manufacturer's recommended pressures.
- ▲ Never connect or disconnect a hose or line containing pressure; it may whip and/or cause hazardous airborne dust and dirt particles. Wear eye protection. Slowly open connections with care, and verify that no pressure is present. Never remove a component or plug unless you are certain all system pressure has been depleted.
- ▲ Use only genuine Bendix® brand replacement parts, components and kits. Replacement hardware, tubing, hose, fittings, wiring, etc. must be of equivalent size, type and strength as original equipment and be designed specifically for such applications and systems.
- ▲ Components with stripped threads or damaged parts should be replaced rather than repaired. Do not attempt repairs requiring machining or welding unless specifically stated and approved by the vehicle and component manufacturer.
- ▲ Prior to returning the vehicle to service, make certain all components and systems are restored to their proper operating condition.
- ▲ For vehicles with Automatic Traction Control (ATC), the ATC function must be disabled (ATC indicator lamp should be ON) prior to performing any vehicle maintenance where one or more wheels on a drive axle are lifted off the ground and moving.
- ▲ The power **MUST** be temporarily disconnected from the radar sensor whenever any tests **USING A DYNAMOMETER** are conducted on a vehicle equipped with a Bendix® Wingman® system.
- ▲ You should consult the vehicle manufacturer's operating and service manuals, and any related literature, in conjunction with the Guidelines above.

DISASSEMBLY OF CLUTCH PEDAL AND/OR BRAKE PEDAL FOR VEHICLES WITH A STANDARD TRANSMISSION

1. Disconnect the power source and the Driver Control Module (DCM) wire harness from the cab wire harness.
2. Disconnect the clutch linkage by removing the shoulder bolt that secures the linkage to the bell crank.



If the vehicle is a standard transmission vehicle (clutch pedal present), the DCM must be removed from the vehicle before the brake (3) or clutch pedal (1) can be replaced. Refer to the guidelines from International® for removal of the DCM.

3. Remove the clutch return spring from the bell crank and clutch return spring post.
4. Fully depress the clutch pedal (1) and clamp it into position.

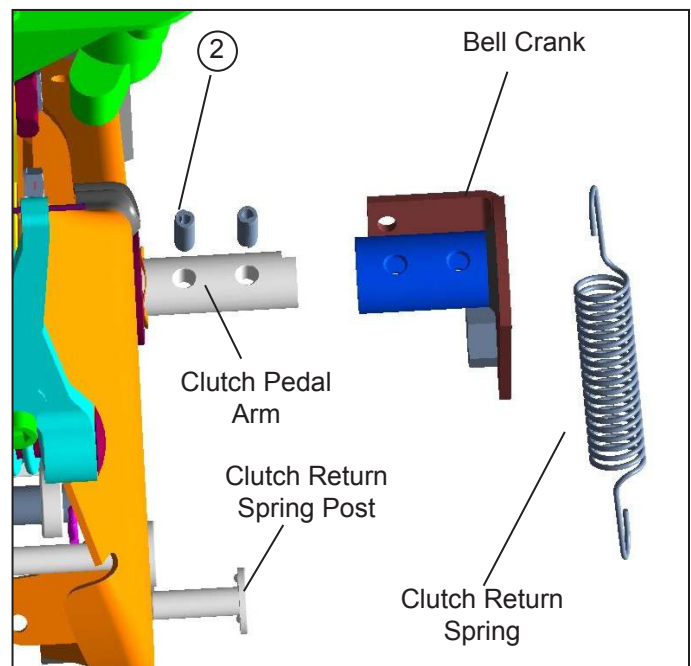

Figure 3 – Disassembly - Bell Crank Removal

5. With a hammer and punch, drive the roll pins (2) out of the bell crank.
6. Slide the bell crank off of the clutch pedal arm. *Refer to Figure 3.*
7. Remove the cotter pin or Rue™ ring (5) that secures the yoke pin (4) to the brake pedal yoke. *Refer to Figure 4.* Remove the yoke pin (4) and, for air-braked vehicles, remove the wave washer (6).
8. Hydraulic vehicles with a Hydromax® brake system contain a brake switch that the yoke pin (4) passes through. The electrical connector does not need to be disconnected. If the brake pedal (3) is being replaced, remove the wire harness clip from the top of the brake pedal (3).

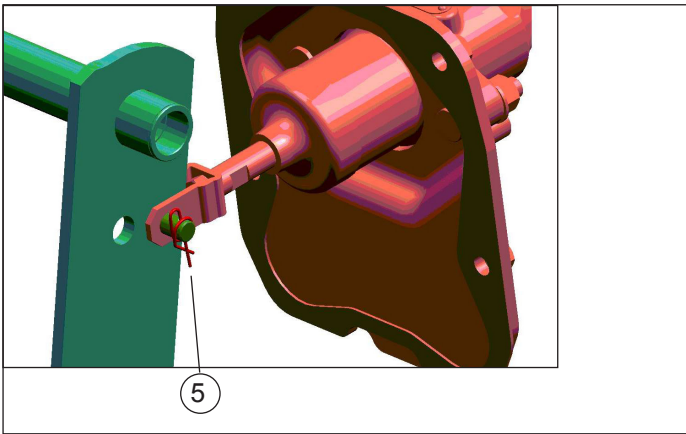

Figure 4 – Rue™ Ring

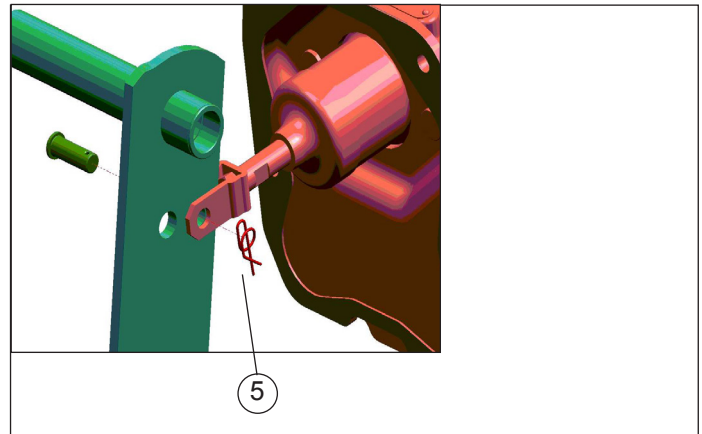

Figure 5 – Rue Ring Installation

9. Unclamp the clutch pedal (1) and gently pull the clutch pedal (1) from the housing. If replacing the clutch pedal (1) only, go to the clutch pedal (1) assembly instructions. If replacing the brake pedal (3), remove the brake pedal (3). Retain all components that are not being replaced by this kit.

DISASSEMBLY OF THE BRAKE PEDAL FOR VEHICLES WITH AN AUTOMATIC TRANSMISSION

1. Remove the cotter pin or Rue™ ring (5). Remove the yoke pin (4) that secures the yoke to the brake pedal (3). For air-braked vehicles, remove the wave washer (6).
2. Hydraulic vehicles with the Hydromax® brake system contain a brake switch that the yoke pin (4) passes through. The electrical connector does not need to be disconnected, but the wire harness clip needs to be removed from the top of the brake pedal (3). Refer to Figure 6.
3. Remove the 3/8" flange screw (8) from the left end of the clutch shaft.
4. Remove the shaft by pulling it towards the passenger side of the vehicle.
5. Remove the brake pedal (3) from the pedestal.

ASSEMBLY OF THE CLUTCH PEDAL AND/OR BRAKE PEDAL FOR VEHICLES WITH A STANDARD TRANSMISSION

1. If replacing the brake pedal (3), position the brake pedal (3) into the driver control pedestal opening. Insert the yoke pin (4) from the driver's side of the vehicle. For air-braked vehicles, attach the wave washer (6) to the yoke pin (4) prior to installation. Note that the yoke pin (4) head may contain two flats—or reliefs—to facilitate the installation. While holding the brake switch in place (if applicable) use a hammer and punch to gently tap the yoke pin (4) through the aligned holes.
2. For hydraulic vehicles with the Hydromax brake system, slide the brake switch into place, straddling the left side of the brake pedal (3) yoke, depressing the switch spring. This will allow the yoke pin (4) holes in the yoke and brake pedal (3) switch to align.
3. Reinstall the cotter pin in the yoke pin (4) hole (if applicable), bending the ends back to approximately 45°. For vehicles using a Rue ring (5), install the Rue ring (5) into the yoke pin (4). Refer to Figure 5. Lock the Rue ring (5) by placing the angled pin under the straight pin as shown in Figure 4.
4. If the brake pedal (3) was replaced, install the wire harness clip into the hole at the top of the brake pedal (3), if applicable.

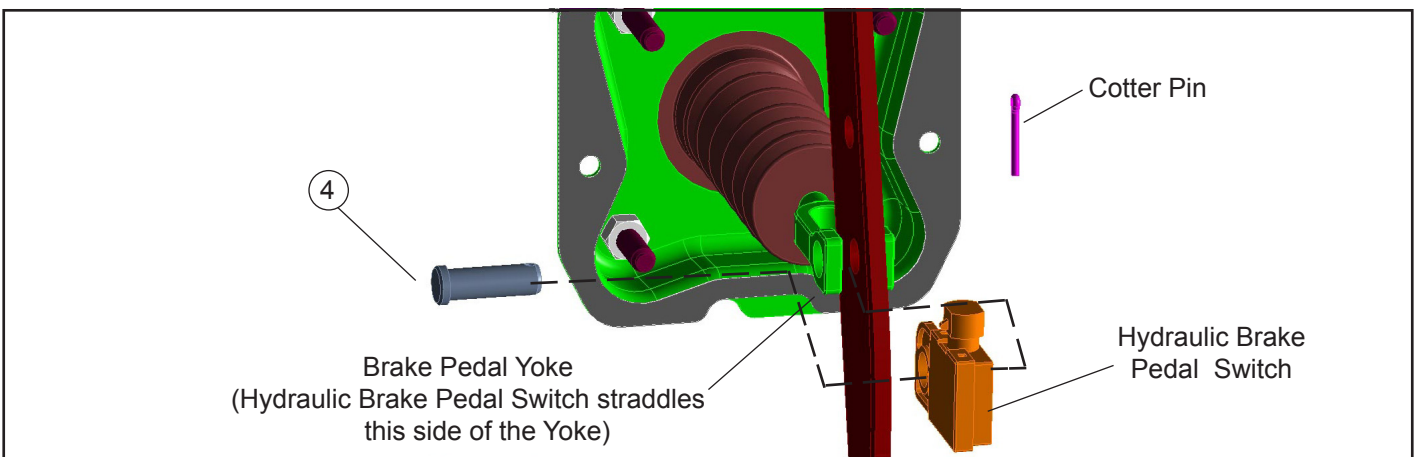

Figure 6 – Installation of the Hydraulic Brake Switch

5. Slide the clutch pedal (1) into the driver control panel and the brake pedal (3) tube. Clamp the clutch pedal (1) into the fully depressed position.
 6. Install the wave washer (6) and bell crank. The flat on the clutch pedal (1) arm, and the internal flat of the bell crank, prevents incorrect alignment. Slide into position until the roll pin (2) holes align.
 7. Install the two roll pins (2) using a hammer and punch if necessary.
 8. Release the clutch pedal (1) clamping mechanism.
 9. Install the clutch return spring on the bell crank and clutch return spring post.
 10. Install the module into the vehicle following the guidelines provided by International®.
 11. Reconnect the clutch linkage and secure it with the shoulder bolt. Tighten to 55–67 ft-lbs.
 12. Adjust the clutch linkage free play per the vehicle manufacturer's guidelines.
 13. Reconnect the DCM wire harness to the cab wire harness.
 14. Reconnect the power source.
2. For hydraulic vehicles with the Hydromax® brake system, slide the brake switch into place, straddling the left side of the brake pedal (3) yoke, depressing the switch spring. This will allow the yoke pin (4) holes in the yoke and brake pedal (3) switch to align.
 3. Reinstall the cotter pin in the yoke pin (4) hole, if applicable, bending the ends back to approximately 45°. For vehicles using a Rue™ ring (5), install the Rue ring (5) into the yoke pin (4) as shown in Figure 5. Lock the Rue ring (5) by placing the angled pin under the straight pin as shown in Figure 4.
 4. Place the brake pedal (3) into position. From the passenger side of the pedestal, insert the clutch shaft through the pedestal and through the brake pedal (3) tube.
 5. Secure the brake pedal (3) and shaft to the pedestal using the 3/8" flange screws (8). Tighten to 220–255 in-lbs.

ASSEMBLY OF THE BRAKE PEDAL FOR VEHICLES WITH AN AUTOMATIC TRANSMISSION

1. Position the brake pedal (3) into the driver control pedestal opening. Insert the yoke pin (4) and wave washer (6) (for air braked vehicles) from the driver's side of the vehicle. For air-braked vehicles, attach the wave washer (6) to the yoke pin (4) prior to installation. Note that the yoke pin (4) head may contain two flats—or reliefs—to facilitate the installation. While holding the brake switch in place (if applicable), use a hammer and punch to gently tap the yoke pin (4) through the aligned holes.

TESTING

1. Turn the key to the on position and test. Verify the clutch (1) and/or brake pedal (3) operates per the vehicle manufacturer's specifications.

Note:

Hydromax® is a registered trademark of the Robert Bosch Corporation.

Rue™ Ring is a trademark of Pivot Point Inc.



Trucking moves fast. Move faster.

Knowledge Dock™

• BLOGS • PODCASTS • VIDEOS • 24/7/365

[knowledge-dock.com]



Log-on and Learn from the Best

On-line training that's available when you are — 24/7/365.

Visit brake-school.com.