

Bendix® BA-921® and BA-922® Remanufactured Compressors

An easy-to-use guide for selecting the best remanufactured compressor—a genuine Bendix® Remanufactured Compressor—for your application.

The following information is included to make your changeover easier than ever:

- Illustrations for visual comparison of the most popular configurations;
- Engine application information;
- A Bendix-piece-number to Bendix-remanufactured-exchange-piece-number cross reference;
- An OE customer-piece-number to Bendix-remanufactured-exchange-piece-number cross reference; and
- Installation accessories and maintenance kits.



Bendix® BA-921®
Remanufactured Compressors
Our most popular configurations.
w/core group and core class identification



BA-921®
 Air Compressor
 (Core Class 2K)
C15, C18
5012533X
(40 tooth drive gear)

CAT®
 Core Group 1K

BA-921®
 Air Compressor
 (Core Class 2K)
C11 Acert®, C13 Acert
5014428X
(42 tooth drive gear)



BA-921®
 Air Compressor
 (Core Class 2K)
5010806X
Rear Flange Rotation - 0°

BA-921®
 Air Compressor
 (Core Class 2K)
5014428X
Rear Flange Rotation - 30°

Rotation
 (30° Shown)

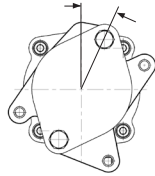

CAT

3126, C7 Acert, C9 Acert
 Core Group 2K

Note: Flange gasket must be purchased from Caterpillar.

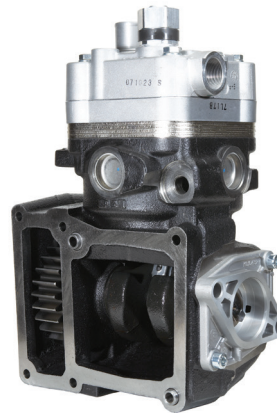

BA-921®
 Air Compressor
 (Core Class 1X)
K075155X

Navistar®
 IBB Side Mount
 Core Group 1X



BA-921®
 Air Compressor
 (Core Class 2J)
5016614X
5016799X (with gasket kit)
(4-bolt head and 63 tooth drive gear with a 21 tooth spline)
 Governor pad included on cylinder head.

BA-921®
 Air Compressor
 (Core Class 2J)
5018653X
(6-bolt head and 63 tooth drive gear with a 21 tooth spline)

DDC®
 Series 60
 Core Group 1J



BA-922® Remanufactured Compressor Configurations

w/core group and core class identification



CAT®
Core Group 1P

BA-922®
Air Compressor
(Core Class 1P)
C11 Acert, C13 Acert
5013058X
(42 tooth drive gear)

BA-922®
Air Compressor
(Core Class 1P)
C15 Acert, C18 Acert
5013059X
(40 tooth drive gear)



DDC®
Series 60 non-EGR &
Series 50
Core Group 1L

BA-922®
Air Compressor
(Core Class 1L)
5013695X
*(69 tooth drive gear
with a 21 tooth spline)*

A changeover kit is required if replacing a Tu-Flo® 750 or DuraFlo 596™ compressor. See BW2524 for additional information.

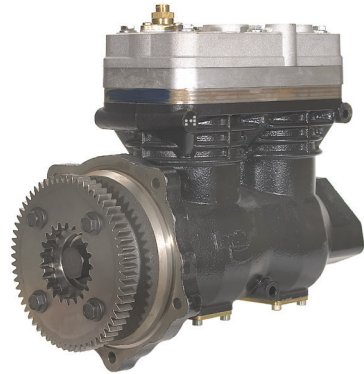

DDC
Series 60 EGR
Core Group 1M

BA-922®
Air Compressor
(Core Class 1M)
5012895X
*(63 tooth drive gear
with a 21 tooth spline)*

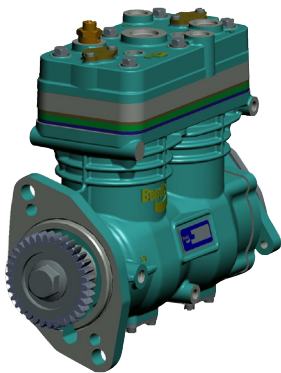

John Deere®
Tier 3 PowerTech Plus™
Core Group 1N

BA-922®
Air Compressor
(Core Class 1N)
5016389X
(drive gear not included)



Accessories and Maintenance Kits



Core Group 05
(Core Class 16)

Bendix® D-2® Governor

| Piece No. | Range (psi) | Comments |
|-----------|-------------|---|
| 065018 | 100-120 | Non-Adjustable |
| 275491X | 100-120 | Adjustable |
| 275707X | 105-125 | Non-Adjustable |
| 284358X | 105-125 | Adjustable High Temp. |
| 800361 | 105-130 | Non-Adjustable Bendix® AD-IS® Air Dryer Application |

Before replacing the governor, be sure to check vehicle requirements to ensure the proper pressure settings.

| Bendix® ST-4™ Safety Valve Piece No. | Thread Size | Hex Size | Number of Exhaust Holes | Pressure Setting |
|--------------------------------------|-------------|----------|-------------------------|------------------|
| 131081 (includes washer) | 1/4-18 | 9/16" | 2 | 250 psi |
| 800154 | 1/2-14 | 7/8" | 2 | |
| 800533 | 3/4-16 | 7/8" | 2 | |
| 800534 | M16 | 7/8" | 2 | |
| 801116 | 7/8-14 | 15/16" | 2 | |

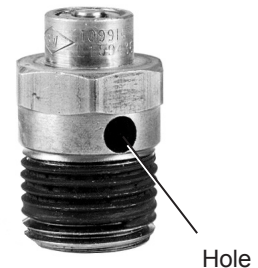

Bendix® ST-4™ Safety Valve

Maintenance Kits

| Kit Description | Part No. |
|---|----------|
| Bendix® BA-921® Compressor Kits | |
| Unloader Kit | K046477 |
| Cylinder Head Gasket Kit | K023764 |
| Compressor Seal Kit | 5012369 |
| Governor Adapter Kit | 5008561 |
| Bendix® BA-922® Compressor Kits | |
| Unloader Kit | K049446 |
| Cylinder Head Gasket Kit | 5014472 |
| Compressor Seal Kit | 5008559 |
| Governor Adapter Kit | 5008561 |
| Changeover Kits: Detroit Diesel® Series 50 & Series 60 Non-EGR | |
| Series 50 CNG | 5015871 |
| Series 50 Diesel, Series 60 non-EGR (<u>rear</u> mount ECM) | 5016263 |
| Series 50 Diesel, Series 60 non-EGR (<u>side</u> mount ECM) | 5016728 |

Compressor Changeover

| Bendix® BA-921® Compressor | |
|---------------------------------------|----------------------------|
| Part No. | Reman. Part No. |
| 5010803 | 5010806X |
| 5011427 | 5012533X |
| 5014401 | 5014428X |
| 5015207 | 5016895X |
| K020283 | 5012533X |
| 5016612 | 5016614X |
| 5018652 | 5018653 |
| K042162 | K075155 |
| K041109 | K055514 |
| K041741 | K055604 |

| Bendix® BA-922® Compressor | |
|---------------------------------------|----------------------------|
| Part No. | Reman. Part No. |
| 801535 | 5012895X |
| 801594 | 5013058X |
| 801595 | 5013059X |
| 801732 | 5013695X |
| 802158 | 5016389X |
| 5011471 | 5012895X |
| 5011616 | 5013695X |
| 5011624 | 5013058X |
| 5011625 | 5013059X |
| 5012893 | 5012895X |
| 5012894 | 5012895X |
| 5012895 | 5012895X |
| 5013058 | 5013058X |
| 5013059 | 5013059X |
| 5013063 | 5013058X |
| 5013064 | 5013058X |
| 5013070 | 5013059X |
| 5013071 | 5013059X |
| 5013262 | 5012895X |
| 5013693 | 5013695X |
| 5013694 | 5013695X |
| 5013695 | 5013695X |
| 5016044 | 5016389X |
| 5016380 | 5016389X |
| 5016381 | 5016389X |
| 5016389 | 5016389X |

| OE Changeover | |
|------------------------|----------------------------|
| Part No. | Reman. Part No. |
| Caterpillar® | |
| 10R-2767 | 5013058X |
| 10R-2768 | 5013059X |
| 20R-0177 | 5014428X |
| 20R-0178 | 5012533X |
| 20R-0176 | 5010806X |
| 226-9579 | 5013058X |
| 226-9580 | 5013059X |
| 257-9346 | 5013058X |
| Detroit Diesel® | |
| 23531136 | 5012895X |
| 23533382 | 5012895X |
| R23533382 | 5012895X |
| John Deere® | |
| RE528181 | 50136389X |
| RE528960 | 50136389X |
| RE528961 | 50136389X |
| Navistar® | |
| 3709920C92 | K075155X |
| 3861777C91 | K055514X |
| 3861777C91 | K055604X |
| North | |
| 6319090 | 5013695X |

Genuine Bendix® compressors are only available through authorized Bendix distributors. Look for the distinctive tag that says “Remfd. by Bendix in U.S.A.” to ensure your product will live up to the rigorous Bendix standards.

At Bendix, our commitment to quality doesn't end when the compressor leaves our location. We stand behind every genuine Bendix remanufactured compressor with

- complete warranty protection from one of the best programs in the industry*
- a comprehensive core return and allowance program*
- a veteran field technical support team to troubleshoot and resolve your air brake system challenges*
- a technical support phone line – representing nearly 45 years of comprehensive collective experience – to supply answers to your questions.*

In addition to the sales and service professionals you deal with face-to-face, there is an entire team working behind the scenes to produce the top quality Bendix products on which you can depend. From research and development to engineering, from production to quality control and marketing, rest assured, you have nearly 85 years of practical experience hard at work for you.



To learn more about Bendix remanufactured compressor – or to find the authorized distributor nearest you – talk to your Bendix account manager, call 1-800-AIR-BRAKE (1-800-247-2725) or visit www.bendix.com.