

Installation Instructions



BENDIX® E-10™ BRAKE VALVE EXHAUST COVER KIT

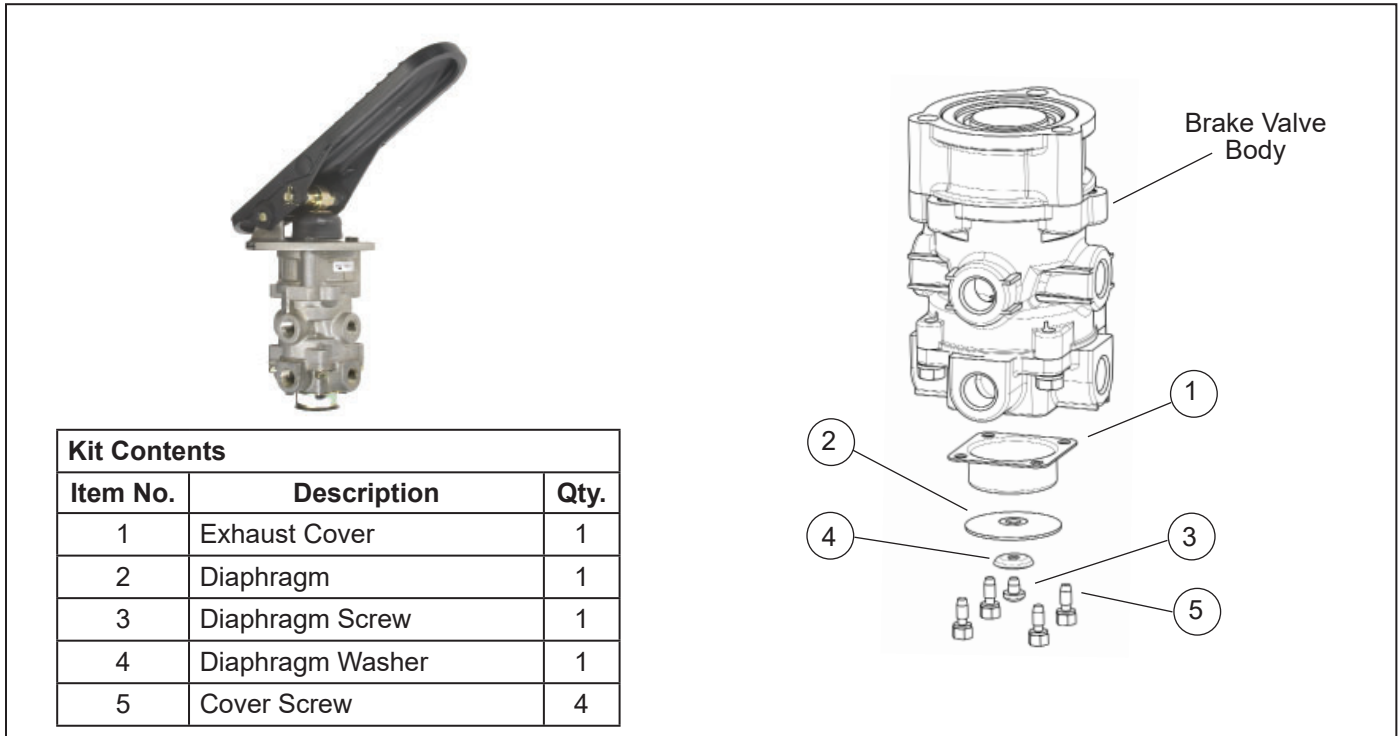

Figure 1 – Bendix® E-10™ Brake Valve Exhaust Cover Kit

DESCRIPTION

This kit contains the items needed for replacing the existing exhaust cover on a Bendix® E-10™ brake valve. It is not necessary to remove the brake valve from the vehicle to install this kit. Refer to Figure 1 for item numbers referenced in parenthesis.

DISASSEMBLY

1. Chock the vehicle wheels or park the vehicle by mechanical means. (Block and hold the vehicle by means other than the air brakes.) Review the General Safety Guidelines on page 2 of this document. Drain all air system reservoirs.
2. Remove and discard the four screws (5) that secure the exhaust cover (1) to the body.
3. Remove the cover (1), diaphragm screw (3), diaphragm washer (4), and rubber diaphragm (2) from the lower body and discard.

Note: Some covers have a gasket installed between the cover and the lower body of the foot brake valve. If applicable, remove and discard the gasket.

4. Clean brake valve around the mounting surface of the exhaust cover (1).

ASSEMBLY

Use all of the components contained in this kit.

1. Install the screws (5) that secure the exhaust cover to the lower body. Torque to 20-40 in-lbs.
2. Using the diaphragm screw (3), install the diaphragm (2) and diaphragm washer (4) onto the exhaust cover (1). Torque diaphragm screw to 5-10 in-lbs.

LEAKAGE CHECK

1. Make and hold a high pressure (80 psi) application.
2. Coat the exhaust port and brake valve body with a soap solution.
3. A one inch bubble in three seconds is permitted.

OPERATIONAL CHECK

Check the delivery pressure of both the “number 1” and “number 2” circuits using test gauges known to be accurate. Depress the treadle to several positions between fully released and fully applied. Check the delivered pressure to see that it varies equally and proportionately with treadle movement.

After releasing a full application, the test gauge reading for both circuits should promptly fall off to zero.

GENERAL SAFETY GUIDELINES



WARNING! PLEASE READ AND FOLLOW THESE INSTRUCTIONS



TO AVOID PERSONAL INJURY OR DEATH:

When working on or around a vehicle, the following guidelines should be observed **AT ALL TIMES**:

- ▲ Park the vehicle on a level surface, apply the parking brakes and always block the wheels. Always wear personal protection equipment.
- ▲ Stop the engine and remove the ignition key when working under or around the vehicle. When working in the engine compartment, the engine should be shut off and the ignition key should be removed. Where circumstances require that the engine be in operation, **EXTREME CAUTION** should be used to prevent personal injury resulting from contact with moving, rotating, leaking, heated or electrically-charged components.
- ▲ Do not attempt to install, remove, disassemble or assemble a component until you have read, and thoroughly understand, the recommended procedures. Use only the proper tools and observe all precautions pertaining to use of those tools.
- ▲ If the work is being performed on the vehicle's air brake system, or any auxiliary pressurized air systems, make certain to drain the air pressure from all reservoirs before beginning ANY work on the vehicle. If the vehicle is equipped with a Bendix® AD-IS® air dryer system, a Bendix® DRM™ dryer reservoir module, a Bendix® AD-9si, AD-HF®, or AD-HF®i air dryer, be sure to drain the purge reservoir.
- ▲ Following the vehicle manufacturer's recommended procedures, deactivate the electrical system in a manner that safely removes all electrical power from the vehicle.
- ▲ Never exceed manufacturer's recommended pressures.
- ▲ You should consult the vehicle manufacturer's operating and service manuals, and any related literature, in conjunction with the Guidelines above.
- ▲ Never connect or disconnect a hose or line containing pressure; it may whip and/or cause hazardous airborne dust and dirt particles. Wear eye protection. Slowly open connections with care, and verify that no pressure is present. Never remove a component or plug unless you are certain all system pressure has been depleted.
- ▲ Use only genuine Bendix® brand replacement parts, components and kits. Replacement hardware, tubing, hose, fittings, wiring, etc. must be of equivalent size, type and strength as original equipment and be designed specifically for such applications and systems.
- ▲ Components with stripped threads or damaged parts should be replaced rather than repaired. Do not attempt repairs requiring machining or welding unless specifically stated and approved by the vehicle and component manufacturer.
- ▲ Prior to returning the vehicle to service, make certain all components and systems are restored to their proper operating condition.
- ▲ For vehicles with Automatic Traction Control (ATC), the ATC function must be disabled (ATC indicator lamp should be ON) prior to performing any vehicle maintenance where one or more wheels on a drive axle are lifted off the ground and moving.
- ▲ The power **MUST** be temporarily disconnected from the radar sensor whenever any tests **USING A DYNAMOMETER** are conducted on a vehicle equipped with a Bendix® Wingman® system.

Log-on and Learn from the Best

On-line training that's available when you are –24/7/365.

Visit brake-school.com.

