

\*\*) ANSENKUNG AN DEN ANSCHLUSSGEWINDEN.  
COUNTER SINKING AT THE PORT THREAD

∅ d1	∅ d7	∅ d5
M12x1.5	12.3 <sup>+0.25</sup>	20

ANZIEHDREHMOMENT FUER INNENGEWINDE TIGHTENING TORQUE FOR INTERNAL THREAD	
M12x1.5	25±5 Nm

OHNE TRITTPLATTE GEZEICHNET  
DRAWN WITH OUT BRAKE PEDAL

ANSICHT B  
VIEW B

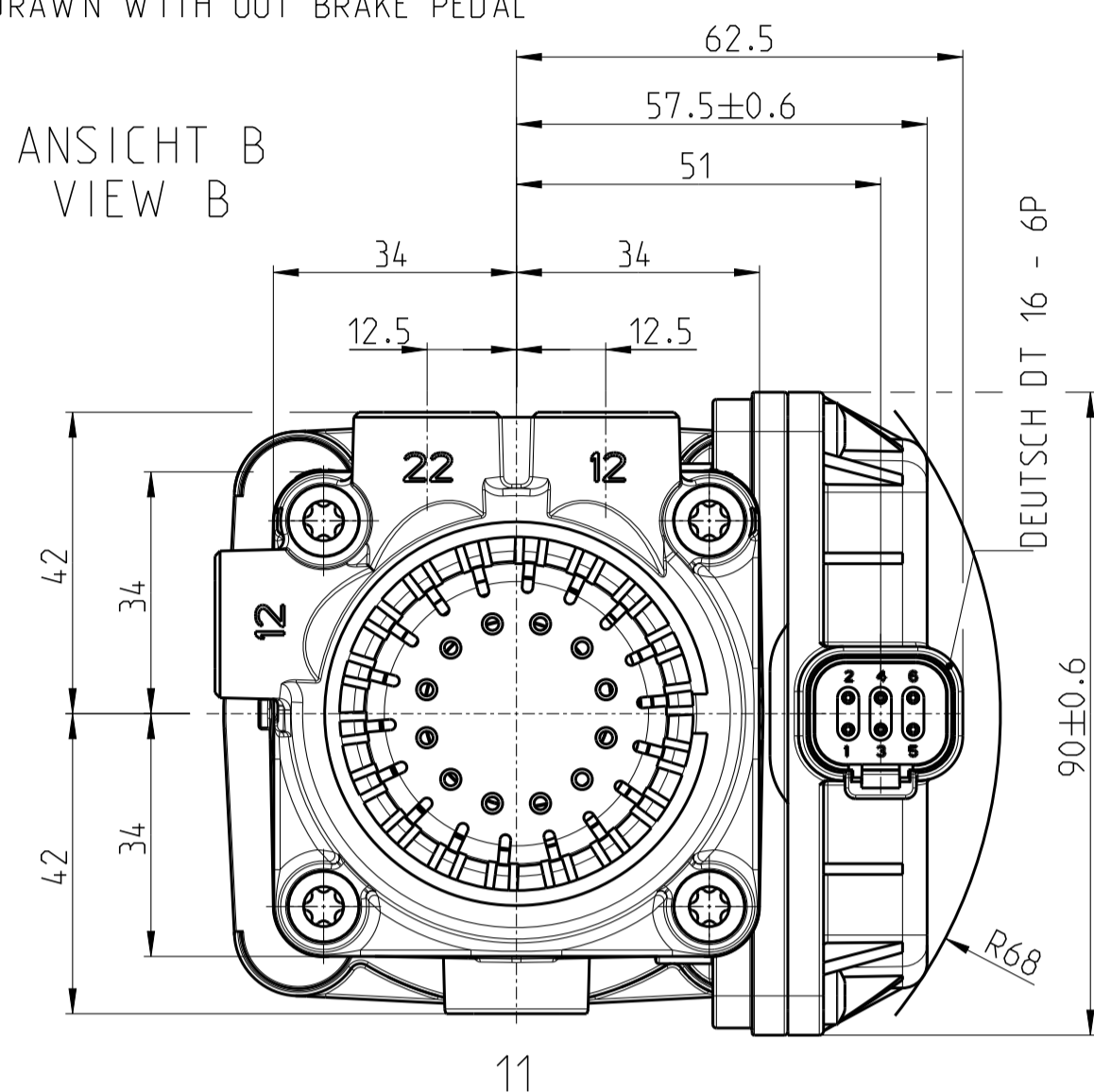

ANSICHT C  
VIEW C

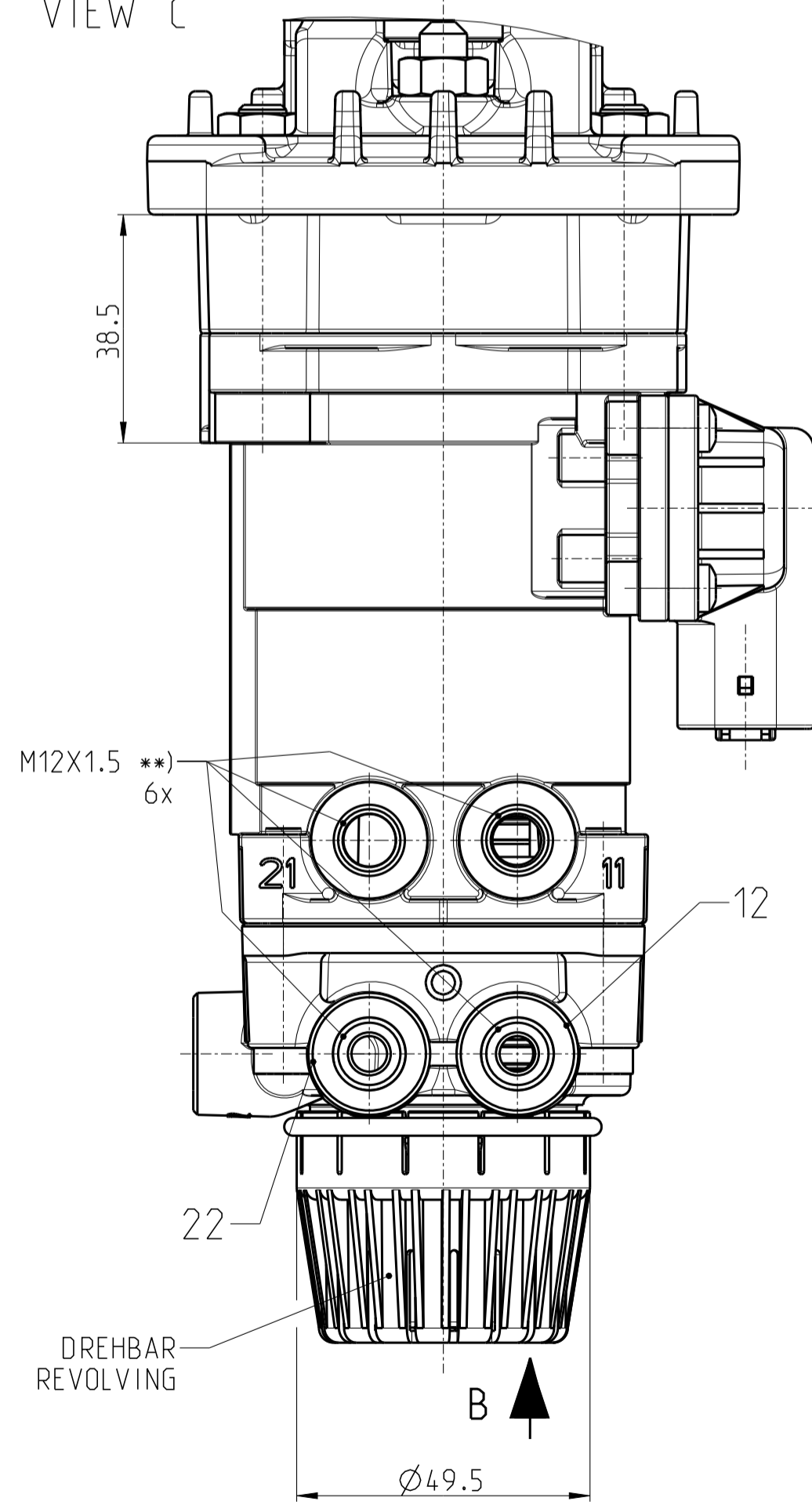

ANSICHT A  
VIEW A

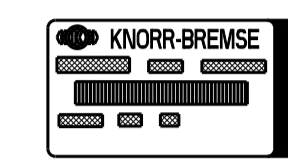

ANSICHT A  
VIEW A

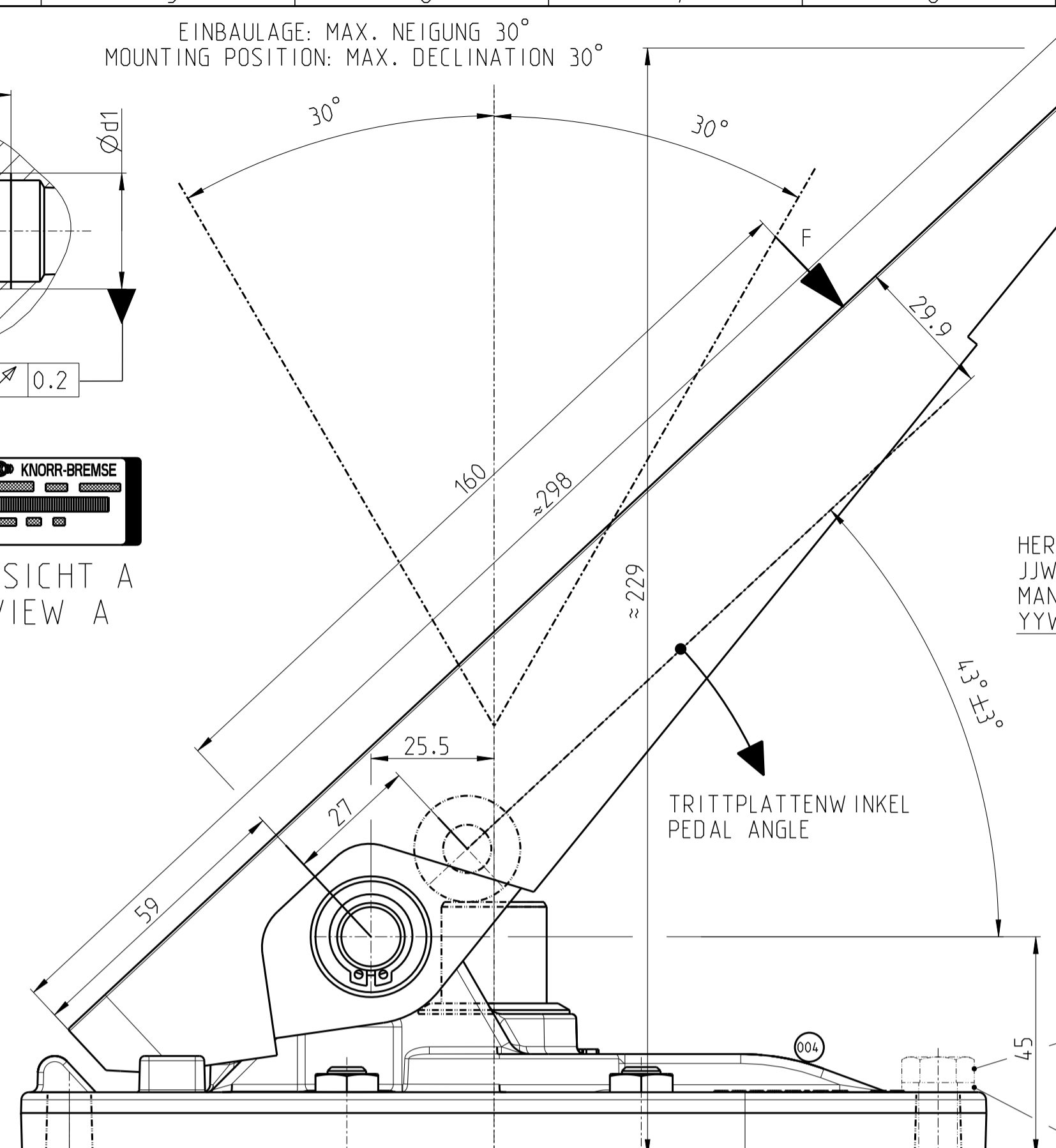

BESTELLNUMMER  
10 STELLEN  
PART NUMBER  
10 SIGNS

PRODUKTGRUPPE  
4 STELLEN  
PRODUCT GROUP  
4 SIGNS

HERSTELLDATUM  
JJWW  
MANUFACTURING DATE  
YYWW

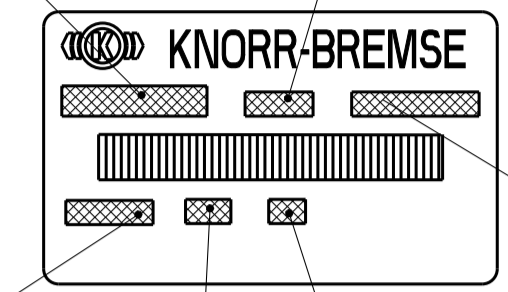

LFD. PRODUKTIONS TAGESNR.  
5 STELLEN  
DAILY ONGOING PRODUCT NUMBER  
5 SIGNS

WERKSKENNZAHL  
2 STELLEN  
PRODUCTION PLANT NUMBER  
2 SIGNS

PRUEFSTANDKENNZAHL  
1 STELLE  
TEST BENCH NUMBER  
1 SIGN

ANZIEHDREHMOMENT (UNGEFETTET) MA = 20 ... 24 Nm  
TIGHTENING TORQUE (NOT GREASED) MA = 20 ... 24 Nm  
3 SECHSKANTSCHRAUBEN DIN EN 24017 M8-8.8-A \*\*)\*)  
3 HEXAGON SCREW DIN EN 24017 M8-8.8-A \*\*)\*)  
3 SCHEIBE DIN 128-8.4-140 HV \*\*)\*)  
3 DISC DIN 128-8.4-140 HV \*\*)\*)

SCHUTZART BEI AUFGESTECKTEN STECKERN DEGREE OF PROTECTION WHEN PLUGGED IN	OBERHALB ANSCHRAUBFLAECHE ABOVE MOUNTING FLANGE	IP 6K 6 (DIN 40050)
THERMISCHER ANWENDUNGSBEREICH PERMISSIBLE TEMPERATURE RANGE	UNTERHALB ANSCHRAUBFLAECHE BELOW MOUNTING FLANGE	IP 6K 9K (DIN 40050)
BETRIEBSDRUCK OPERATING PRESSURE		MAX. 10 bar *) MAX. 10 bars *)
QUERSCHNITT SECTION		∅5 MM VON 11 NACH 21 UND 12 NACH 22 ∅5 MM FROM 11 TO 21 AND 12 TO 22
ZU BEACHTEN: MAX. ZULAESSIGE BETAETIGUNGSKRAFT F = 2400 N		
PAY ATTENTION: MAX. PERMISSIBLE OPERATING FORCE F= 2400 N		
ELEKTRISCHE VERSORGUNG ERFOLGTE UEBER ELEKTRONISCHES STEUERGERAET ELECTRICAL SUPPLY BY ELECTRONIC CONTROL UNIT		

STECKERBELEGUNG  
CONNECTOR ASSIGNMENT

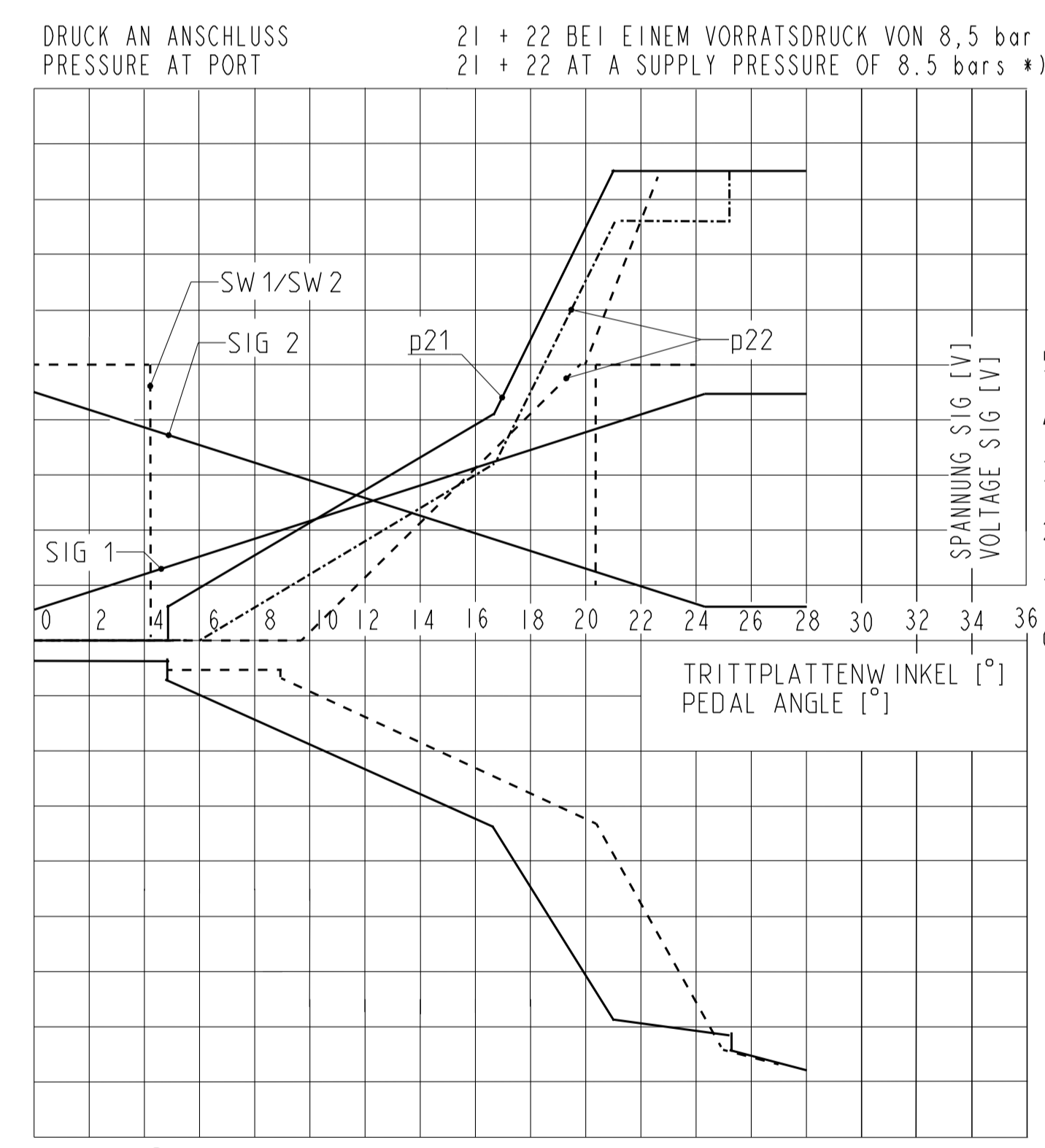
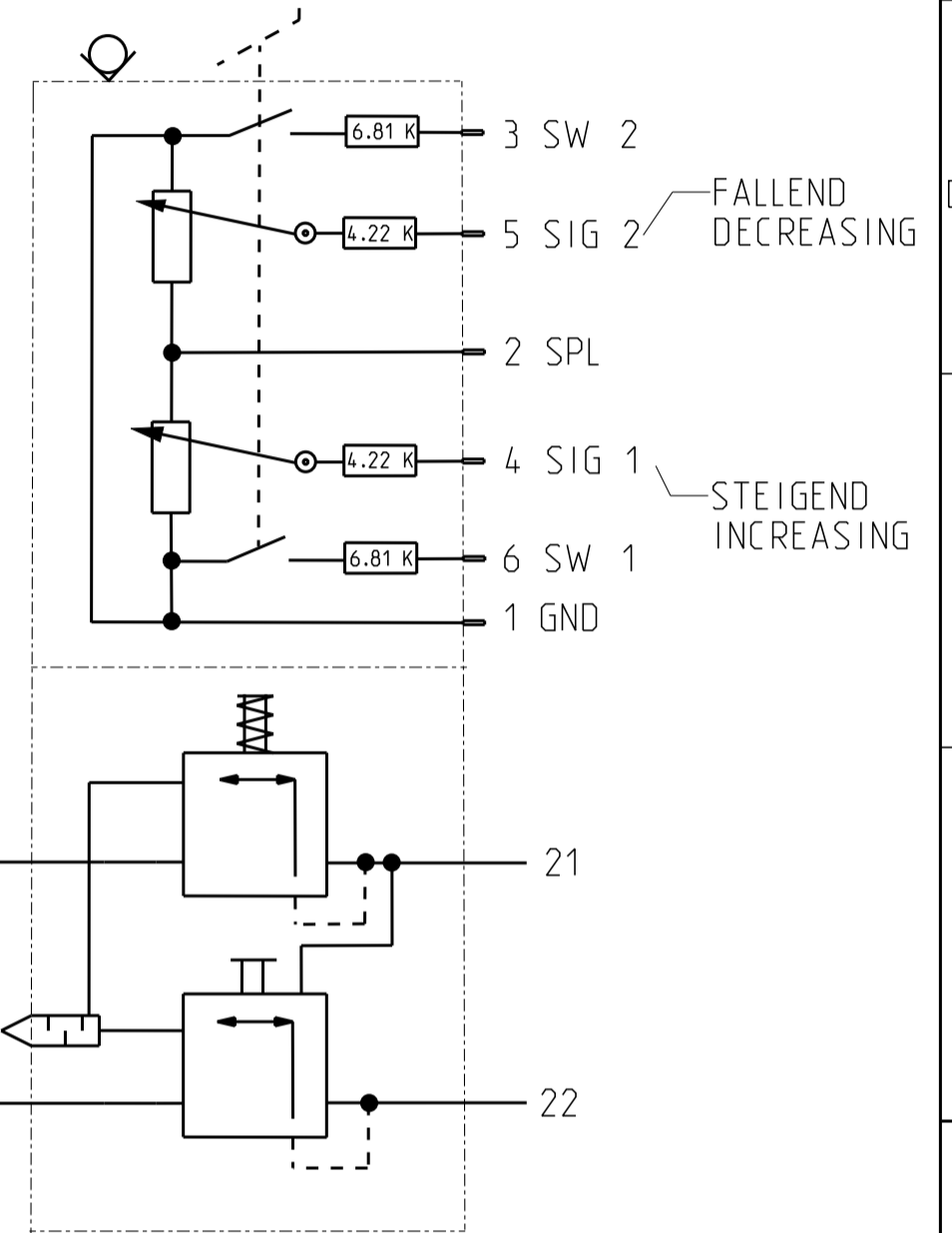
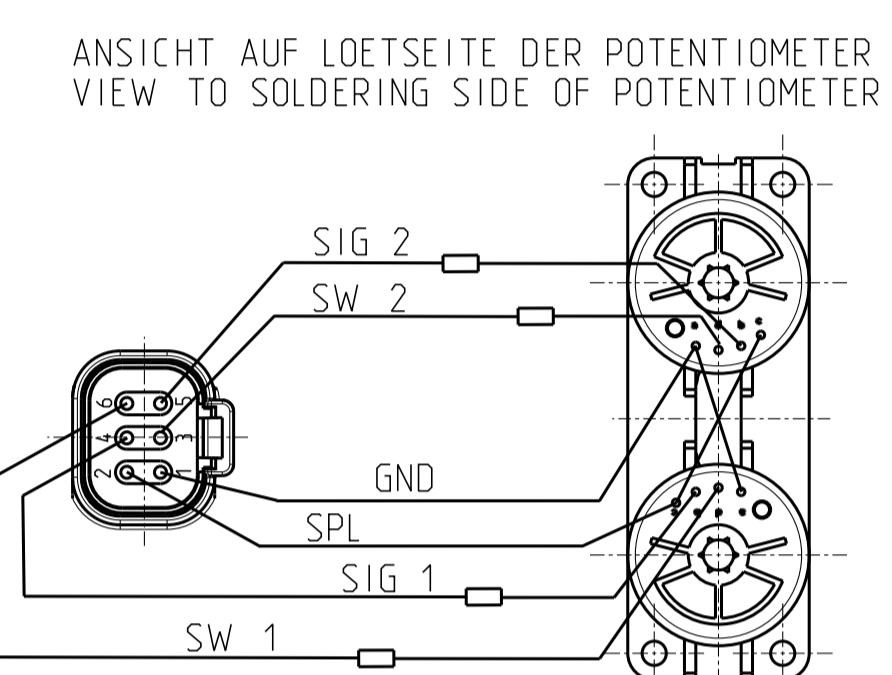

— KREIS 1 INTAKT UND AUSFALL VON KREIS 2  
CIRCUIT 1 INTACT AND A FAILURE OF CIRCUIT 2  
- - - KREIS 2 INTAKT  
CIRCUIT 2 INTACT  
- · - KREIS 2 BEI AUSFALL VON KREIS 1  
CIRCUIT 2 AT A FAILURE OF CIRCUIT 1

11 = ENERGIEZUFLOSS KREIS 1 ENERGY INLET CIRCUIT 1	12 = ENERGIEZUFLOSS KREIS 2 ENERGY INLET CIRCUIT 2
21 = ENERGIEABFLUSS BREMSKREIS 1 ENERGY SUPPLY BRAKE CIRCUIT 1	22 = ENERGIEABFLUSS BREMSKREIS 2 ENERGY SUPPLY BRAKE CIRCUIT 2
3 = ENTLUEFTUNG EXHAUST	
GEGENSTECKER COUNTER PLUG CONNECTOR	DEUTSCH DT 16 - 6S
KODIERUNG WEDGE	OHNE WITHOUT

\*) WERTE IN UBERDRUCK ANGEZEIGT  
VALUE IN EXCESSIVE PRESSURE  
\*\*\*) VERZINKT UND GELB CHROMATIERT  
ZINCED AND YELLOW CHROMATED

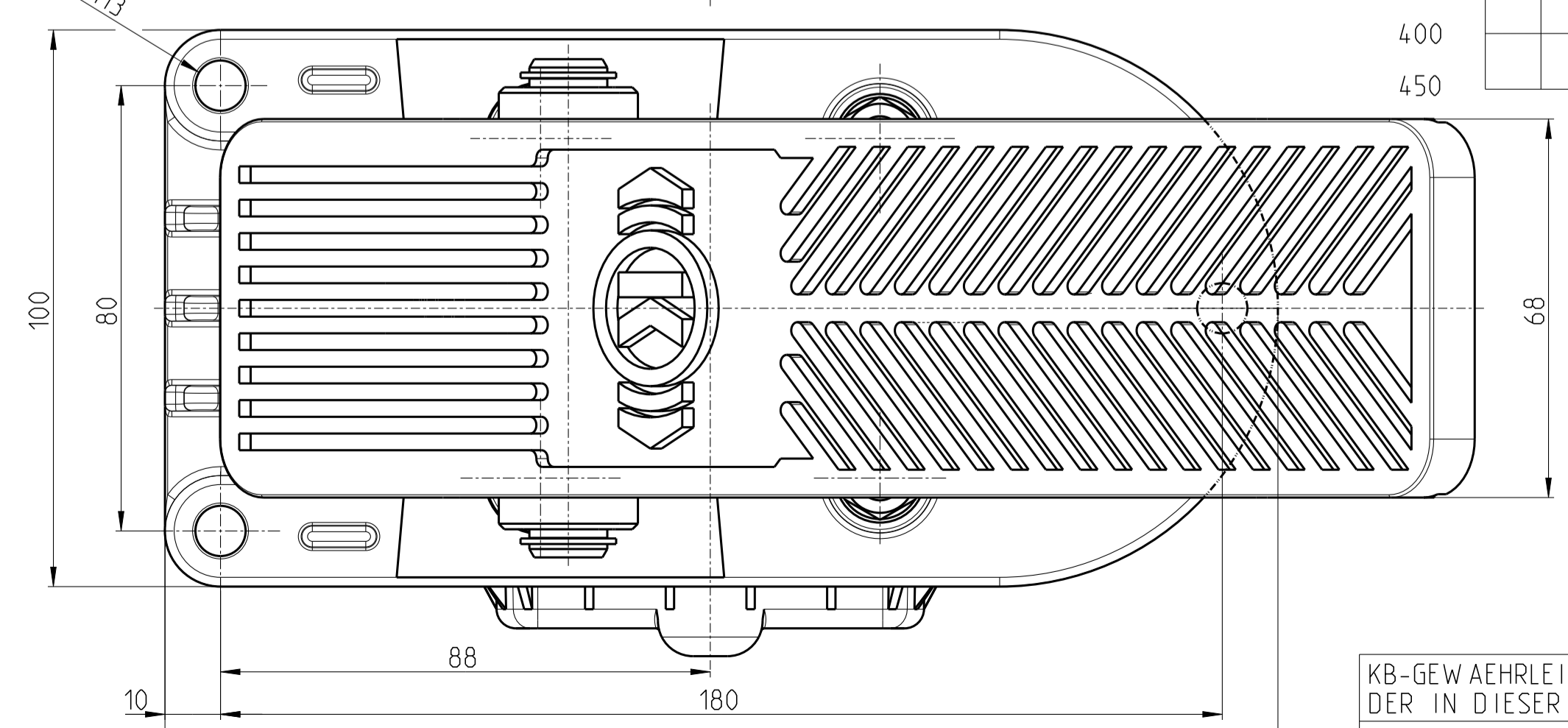

21 EC	K024928N00	
PRODUKTGRUPPE PRODUCT GROUP	TEILENUMMER PART NUMBER	KUNDENUMMER CUSTOMER NUMBER

KB-GEWAEHRLEISTUNG FUER DIE FUNKTION DES STECKSYSTEMS NUR BEI VERWENDUNG DER IN DIESER ANGEBOOTSZEICHNUNG VORGESCHRIEBENEN GEGENSTECKER-SYSTEMEILE.  
KB WARRANTY WILL COVER THE FUNCTION OF THE CONNECTOR SYSTEM ONLY IN CASE OF COMBINATION WITH OPPOSITE CONNECTOR SYSTEM PARTS ACCORDING TO THIS OFFER DRAWING

NOT TOLERATED DIMENSIONS: ±1mm / ±5°	
005 1471951 004 1433779	10.10.2022 JWK 01.11.2021 Katta
Rev. Revision Reference	Date Name
Numbers of described parts: ISO 128-30	Special Characteristics: 0 [S] [C] [E] [C]
K024928N00	Tolerancing Principle: [C/C]
CAD Model No.: M305535	General Tolerances: Made from: -x-
Systeme für Nutzfahrzeuge GmbH	Material: -
Knorr-Bremse	EBS-Fuß Brake Module
Release Process Documentation in EDM, Level and Status Information in Watermark.	EBS-Fussbremsmodul
Drawn: 2010/01/19 Knoeller	Drawing Number: Z030848
Knorr-Bremse Group	Doc-Type: ID Language: DE
	Draw-Rev: 005
	Sheet 1 of 1

This document contains proprietary and confidential information and such information may not be disclosed without the prior written consent from the Knorr-Bremse organization